

City of Port Phillip
Advertised Plan 1 of 3



PLANT SCHEDULE

SYM	Botanical Name	Common Name	Max. Height	Min. Spread	Spacing	Per Lot	Quantity
Shrub Leaf Plants & Grasses							
UCP	Lomandra confertifolia Little Pal	Little Pal Lomandra	0.5m	0.2m	400mm	16m	111
NSOP	Neonectandra gracilis	Wahingiro	0.4m	0.2m	300mm (square)	16m	120
Ground Covers							
ANCO	Asplenium acrostichum	Baby Sunbeam	0.2m	0.2m	300mm	16m	40
CSAG	Conyza bonariensis	White Fieldfox	0.2m	0.2m	400mm	16m	18
DCNF	Drosera rotundifolia	Roundleafed Sundew	0.1m	0.1m	500mm	16m	82
LDSE	Lilium serotinum	Perpetual Bell	0.3m	0.2m	700mm	16m	182
RSPE	Rhynchospora affinis Procumbens	Prostrate Rush	0.2m	0.2m	400mm	16m	120
Climbers							
AFRE	Asplenium nidus	Queen Fern	structure size	structure size	1.5m	16m	5
BDOL	Bougainvillea glabra	Bougainvillea Variety	structure size	structure size	As plan	30m	10
CSST	Clematis vitalba	White Clematis	structure size	structure size	1.5m	16m	113
FRAD	Persea indica	Wax Tree	structure size	structure size	1.5m	16m	4
PLTE	Persea indica	Wax Tree	structure size	structure size	2m	16m	1
PTLO	Persea indica	Wax Tree	structure size	structure size	1m	16m	2
TRGP	Thymus praecox	Blue Thyme	structure size	structure size	2m	16m	19

THISTLETHWAITE STREET

NOTES

SURFACES LEGEND

- GARDEN BED - NATURAL SOIL**
 - 100mm to 200mm existing soil to be retained in situ. Depth of 100mm.
 - Organic Compost Mulch to 100mm.
- GARDEN BED - LIGHTWEIGHT SOIL**
 - Specialist lightweight 100mm to 200mm.
 - 100mm to 200mm.
 - Organic Compost Mulch to 100mm.
- CONCRETE PAVING**
 - 100mm 100% granite aggregate.
 - No sand.
- CEMENT**
 - In-situ concrete.
- CONCRETE PAVING - PERMEABLE**
 - 100mm to 150mm.
 - Permeable concrete.
- FOOTPATH**
 - 100mm to 150mm.
 - Permeable concrete.

Refer to relevant E-GA Specifications for general surfacing requirements.
Refer to Architect's Details & Specifications and Structural Engineer for structural details.

STRUCTURES LEGEND

- TENSORED WIRE**
 - 100mm to 150mm.
 - 100mm to 150mm.
 - 100mm to 150mm.
 - 100mm to 150mm.
- TENSORED WIRE**
 - 100mm to 150mm.
 - 100mm to 150mm.
 - 100mm to 150mm.
 - 100mm to 150mm.

IRRIGATION

Surface irrigation is to be used for all planned garden beds. Above ground systems are to be used for all contained plantings.
Irrigation is to utilize horizontal riser pipe with rotary head up.
Irrigation lines are to include an automatic backflow preventer - RETICER-KOOLER or similar. Irrigation system design is to be submitted to E-GA for approval prior to installation.

EXISTING TREE SCHEDULE

- EX.01 - Melaleuca alternifolia - RETAIN + PROTECT
- EX.02 - Melaleuca alternifolia - RETAIN + PROTECT
- EX.03 - Melaleuca alternifolia - RETAIN + PROTECT
- EX.04 - Callistemon sp. - RETAIN + PROTECT
- EX.05 - Callistemon sp. - RETAIN + PROTECT
- EX.06 - Callistemon sp. - RETAIN + PROTECT

TREE PROTECTION

shrub works in accordance with AS 4970-2009 (Protection of Trees on Development Sites)

PLANTING

Plants to be used are to be selected from the provided plant list with all plants conforming to the species, size and quality indicated in the Plant Schedule.
Plants are to meet the following characteristics:
- be healthy and free from pests and diseases; they will be vigorous and established; have been grown and cared for in good soils, consistent with the species or safety hardened off - not in a pot.
Plants that do not meet these requirements will be rejected.
Plant pot sizes and numbers will be determined by site availability as per the Plant Schedule.
E-GA reserves the right to make suitable substitutions as required in order to achieve planting design intent.
Spacing in individual sites, numbers are to be increased evenly over the area indicated on the plan.
It is suggested that E-GA check over placement of plants prior to installation.

PLANNING

ecobase
SOUTH AUSTRALIA

Project: 155-162 Thistlethwaite St
South Melbourne VIC

Client: THISTLETHWAITE ST
Date: DEC 2017
Scale: 1:500 (A1)

Drawing Title: LANDSCAPE PLAN - GF
Drawing No: TH-2017-01-01
Drawn: RB

Copyright: Ecobase Architecture Pty Ltd
PO Box 5006 Burnley VIC 3181 Australia
T: 61 3 9415 1022
info@ecobase.com.au www.ecobase.com.au

All measurements must be verified on site before commencing any construction.
An outline drawing of the proposed site plan must be independently checked by a qualified engineer.
Landscape and site plan numbers are to be verified on site.

City of Port Phillip
Advertised Plan 2 of 3

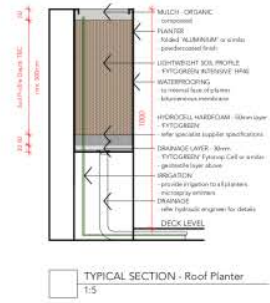

NOTES

- SURFACES LEGEND**
- GARDEN BED - NATURAL SOIL**
 - 100mm MUGH ORGANIC topsoil
 - 100mm FRAZEE 100mm MULMULMUL in water permeable fabric
 - 100mm LIGHTWEIGHT SOIL PROFILE FYTODREN EXTENSIVE 100mm
 - Waterproofing to internal level of planter
 - Hydrocell membrane 100mm layer
 - FYTODREN with specific supplier specifications
 - Drainage layer 100mm
 - FYTODREN Fyning Cell or similar geotextile layer above
 - Irrigation pipe to support roof planter
 - Drainage with hydraulic engineers for details
 - Deck level
 - GARDEN BED - LIGHTWEIGHT SOIL**
 - Specialist lightweight Fyning
 - Hydrocell membrane
 - Organic Compost Mulch to 100mm
 - CONCRETE PAVING**
 - 100mm 100mm 100mm aggregate
 - No sand
 - DECKING**
 - To architect specification
 - CONCRETE PAVING - PERMEABLE**
 - Permeable concrete
 - Permeable concrete
 - FOOTPATH**
 - Permeable concrete
 - Permeable concrete

Refer to relevant E-GA Specifications for general surfacing requirements.
Refer to Architect's Details & Specifications and Structural Engineer for structural details.

STRUCTURES LEGEND

- TENSIONED WIRE**
 - 10mm 10mm 10mm
 - 10mm 10mm 10mm
 - 10mm 10mm 10mm
- TENSIONED WIRE**
 - 10mm 10mm 10mm
 - 10mm 10mm 10mm
 - 10mm 10mm 10mm

IRRIGATION

Surface irrigation is to be used for all planted garden beds. Above-swing emitters are to be used for all constrained plantations.
Irrigation is to utilize horizontal riser pipe with mainline back-up.
Irrigation lines are to include manufacturer's expansion capability - RIBBET-K-CORP or similar.
Irrigation system design is to be submitted to E-GA for approval prior to installation.

EXISTING TREE SCHEDULE

- EX-01 - Melia azadirachta - RETAIN + PROTECT
- EX-02 - Melia azadirachta - RETAIN + PROTECT
- EX-03 - Melia azadirachta - RETAIN + PROTECT
- EX-04 - Callistemon sp. - RETAIN + PROTECT
- EX-05 - Callistemon sp. - RETAIN + PROTECT
- EX-06 - Callistemon sp. - RETAIN + PROTECT

TREE PROTECTION

skirting works in accordance with AS 4970-2009 (Protection of Trees on Development Sites)

PLANTING

Planting shall be carried out using material for rootball protection with all plants conforming to the species, size and quality indicated in the Plant Schedule.
Plants are to have the following characteristics:
- kept in the root system with no evidence of root cut or pot bound restriction or damage; they will be vigorous and established, free from disease and pests and of good form, consistent with the species or safety hardened off - not to be listed.
Plants that do not meet these requirements will be rejected.
Plant pot sizes and numbers will be determined by site availability as per trees of equal value.
E-GA reserves the right to make suitable substitutions as required in order to achieve planting design intent.
Spacing in individual rows, numbers are to be spread evenly over the area indicated on the plan.
It is suggested that E-GA check over placement of plants prior to planting.

SYM	Botanical Name	Common Name	Mat. Height	Mat. Spread	Spacing	Pot Size	Quantity
Strip-Leaf Plants & Grasses							
UGP	Lomandra confertifolia Little Pal	Little Pal Lomandra	0.5m	0.2m	400mm	16cm	111
NSOP	Neomeris spicata	Whiting Iris	0.4m	0.4m	300mm (square)	16cm	120
Ground Covers							
ANCO	Asplenium adnigrum	Black Juniper	0.2m	0.2m	300mm	16cm	40
CSAG	Conyza bonariensis	White Fieldfox	0.2m	0.2m	400mm	16cm	18
DCRF	Drosera rotundifolia	Round-leaved Sundew	0.1m	0.1m	500mm	16cm	82
LDSE	Lilium denudatum	Parrot's Beak	0.2m	0.2m	700mm	16cm	182
ESPE	Epimedium alpinum	Prostrate Runewort	0.2m	0.2m	400mm	16cm	120
Cliviers							
APRE	Asplenium platyneuron	Spinney Fern	0.2m	0.2m	300mm	16cm	5
BDOL	Begonia bolanderi	Begonia Bolanderi	0.2m	0.2m	300mm	16cm	10
CSST	Conyza spicata	White Fieldfox	0.2m	0.2m	300mm	16cm	113
FRAD	Fragaria vesca	Wild Strawberry	0.1m	0.1m	300mm	16cm	4
FRIT	Fragaria vesca	Wild Strawberry	0.1m	0.1m	300mm	16cm	5
PTLO	Polka Dot Plant	Polka Dot Plant	0.1m	0.1m	300mm	16cm	2
TRIP	Thymus praecox	Wild Thyme	0.1m	0.1m	300mm	16cm	19

THISTLETHWAITE STREET

PLANNING

ecology
SOUTH AUSTRALIA

Ecology South Australia Pty Ltd
PO Box 506, Burnley ST1 100, Adelaide SA 5000
T: 81 241 022
info@ecology.com.au www.ecology.com.au

Address: 155-162 Thistlethwaite St
South Melbourne VIC
All plans require planning applications and are to be submitted to the relevant authority for approval.
Plans are to be submitted to the relevant authority for approval.

Client: THISTLETHWAITE ST
Date: DEC 2017
Project: 155-162 Thistlethwaite St
Scale: 1:50 (A1)
Drawing Title: LANDSCAPE PLAN - 2nd Rev
Drawing No: TH-2017-02
Rev: 001
Drawn By: [Name]

City of Port Phillip
Advertised Plan 3 of 3

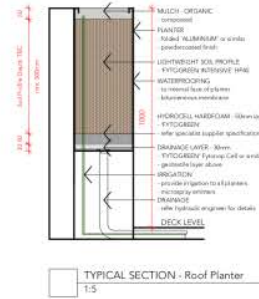

NOTES

- SURFACES LEGEND**
- GARDEN BED - NATURAL SOIL**
 - 100mm topsoil to grade
 - 100mm topsoil to 100mm depth of 500mm
 - Organic Compost Mulch to 100mm
 - GARDEN BED - LIGHTWEIGHT SOIL**
 - Specialist lightweight Fytilite
 - 100mm MULCH/COMPOST
 - Organic Compost Mulch to 100mm
 - CONCRETE PAVING**
 - 100mm 1000T polymer aggregate
 - 100mm concrete
 - DECKING**
 - 100mm timber decking
 - CONCRETE PAVING - PERMEABLE**
 - 100mm concrete
 - 100mm 1000T polymer aggregate
 - PODFATH**
 - 100mm 1000T polymer aggregate
 - 100mm concrete
- Refer to Urban E-G Specifications for general surfacing requirements
- Refer to Architect's Details & Specifications and Structural Engineer for structural details

- STRUCTURES LEGEND**
- TENSIONED WIRE**
 - 100mm 1000T steel 3.0mm
 - 100mm 1000T steel 3.0mm
 - 100mm 1000T steel 3.0mm
 - 100mm 1000T steel 3.0mm
 - TENSIONED WIRE**
 - 100mm 1000T steel 3.0mm
 - 100mm 1000T steel 3.0mm
 - 100mm 1000T steel 3.0mm
 - 100mm 1000T steel 3.0mm
- Tensioned Wire Allowance to be appropriate for the growth of attached climber

- IRRIGATION**
- Surface irrigation is to be used for all planted garden beds. Above-scape irrigation is to be used for all contained planters.
- Irrigation is to utilize handwatered handwater with mains feed-up.
- Irrigation zones are to include subsurface irrigation systems - REFER TO ARCHITECT'S DETAILS FOR IRRIGATION SYSTEM DESIGN. IRRIGATION SYSTEM DESIGN IS TO BE REFERENCED TO E-GA FOR APPROVAL AND INSTALLATION.

- EXISTING TREE SCHEDULE**
- EX-01 - Melaleuca leucadendron - RETAIN + PROTECT
 - EX-02 - Melaleuca leucadendron - RETAIN + PROTECT
 - EX-03 - Melaleuca leucadendron - RETAIN + PROTECT
 - EX-04 - Callistemon sp. - RETAIN + PROTECT
 - EX-05 - Callistemon sp. - RETAIN + PROTECT
 - EX-06 - Callistemon sp. - RETAIN + PROTECT

TREE PROTECTION
during works in accordance with AS 4970-2009 (Protection of Trees on Development Sites)

- PLANTING**
- Planting shall be carried out using standard horticultural practices with all plants conforming to the species, size and quality indicated in the Plant Schedule.
- Plants are to have the following characteristics:
- large healthy root systems with no evidence of root rot or pest bound restriction or damage; they will be vigorous and established, free from disease and pests, and of good form, consistent with the species or safety hardened off - not to be boxed.
- Plants that do not meet these requirements will be rejected.
- Plant pot sizes and numbers will be determined by site availability as per terms of quotation.
- E-GA reserves the right to make suitable substitutions as required in order to maintain planting design intent.
- Spacing is indicative only. Numbers are to be spread evenly over the area indicated on the plan.
- It is suggested that E-GA check over placement of plants prior to planting.

SYM	Botanical Name	Common Name	Mat. Height	Min. Spread	Spacing	Pot Size	Quantity
Shrub Leaf Plants & Grasses							
LOPP	Lomandra confertifolia Little Pal	Little Pal Lomandra	0.5m	0.2m	400mm	16cm	111
NSOP	Neesiostrum gracile	Woolly-top	0.4m	0.4m	300mm (square)	16cm	120
Ground Covers							
ARCO	Asplenium australasicum	Baby's Tears	0.2m	0.2m	300mm	16cm	40
CRAG	Cratichneum	Native Figwort	0.2m	1.0m	400mm	16cm	18
DCNF	Drosera rotundifolia	Round-leaved Sundew	0.1m	1.0m	500mm	16cm	82
LOBE	Lobelia sp. (Blue)	Periwinkle Blue	0.2m	0.2m	700mm	16cm	182
ROSE	Rosemary officinalis Prostrata	Prostrate Rosemary	0.4m	1.0m	400mm	16cm	120
Climbers							
AFRE	Azorella frutescens	Climb Rose	structure size	structure size	1.5m	16cm	5
BDOL	Bougainvillea glabra	Bougainvillea Variety	structure size	structure size	As plan	30cm	10
CSST	Clematis vitalba	Witch's Sticks	structure size	structure size	1.5m	16cm	113
FRAD	Passiflora foetida	Wild Passionfruit	structure size	structure size	1.5m	16cm	4
WITE	Wisteria floribunda	Wisteria	structure size	structure size	2m	16cm	3
PTLO	Passiflora ligularis	Tree Lardier	structure size	structure size	1m	16cm	2
TRIP	Triplaris grandifolia	Blue Triplaris	structure size	structure size	2m	16cm	10

THISTLETHWAITE STREET



Project: 150-162 Thistlethwaite St
 150-162 Thistlethwaite St
 South Melbourne VIC
 3146
 03 9594 1000
 www.gardenia.com.au

Client: THISTLETHWAITE ST
 Date: DEC 2017
 Project: 150-162 Thistlethwaite St
 Scale: 1:500 (A1)
 Drawing Title: LANDSCAPE PLAN - Rearing
 Drawing No: TH-2017-03
 Drawn: RB

PLANNING