

**BIKE HOOPS PARALLEL TO KERB  
PLAN**

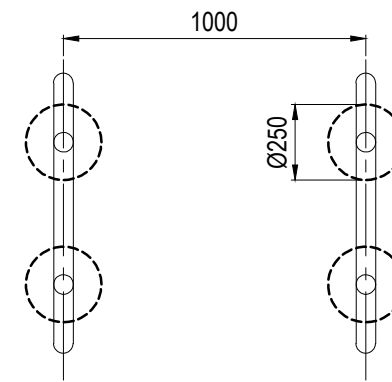

**CORE DRILLED  
TYPICAL PLAN**

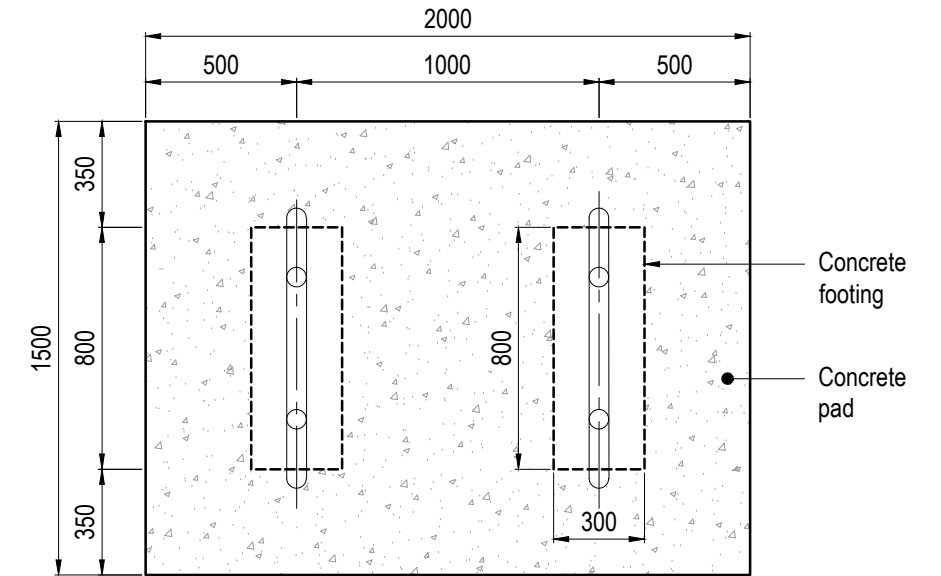

**CONCRETE PAD  
TYPICAL PLAN**

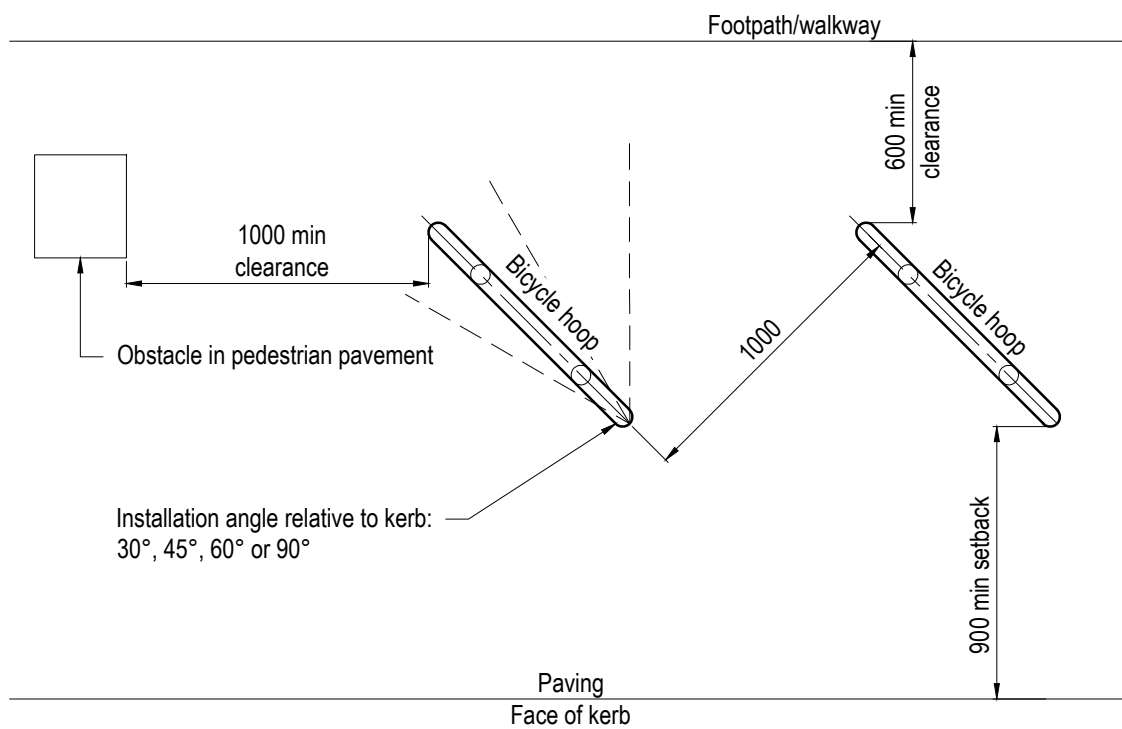

**BIKE HOOPS ANGLED TO KERB  
PLAN**

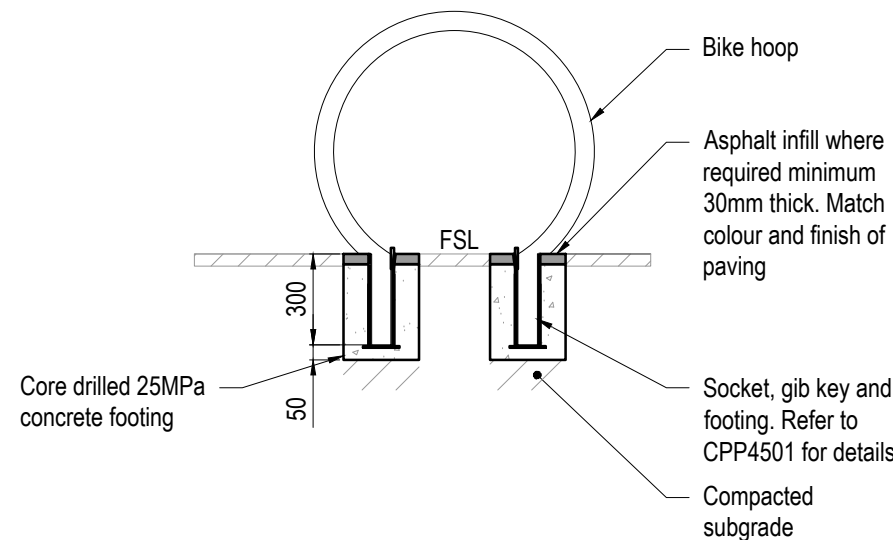

**CORE DRILLED  
TYPICAL SECTION**

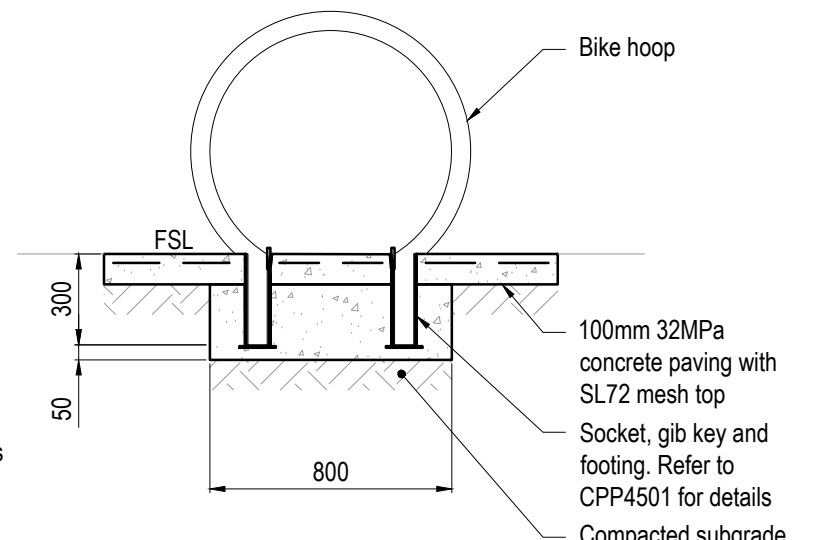

**CONCRETE PAD  
TYPICAL SECTION**

**NOTES**

1. Drawing in millimetres unless noted otherwise.
2. Council to be determine if bike hoop is to be installed using Core Drilled or Concrete Pad footing. Typically core drilled footings are not to be used on asphalt footpaths due to potential damage.
3. Bicycle hoops should be spaced one metre apart and offset a minimum of 900mm from the face of kerb. Hoops are to be placed at an angle of 90°, 60°, 45° or 30° so as not to impede pedestrian access along footpaths. Installation requirements to be specified by Council.
4. For fabrication details contact the City of Port Phillip.
5. Installation of bike hoops must achieve 200mm minimum clearance from edge of concrete footing to edge of any existing service.
6. All bike hoop installation as per AS2890.3.
7. Where excavation will occur, contractor must conduct a Dial Before You Dig ([www.1100.com.au](http://www.1100.com.au)).

**Disclaimer:**

The authors and sponsoring organisations shall have no liability or responsibility to the user or any other person or entity with respect to any liability, loss or damage caused or alleged to be caused, directly or indirectly, by the adoption and use of these Standard Drawings including, but not limited to, any interruption of service, loss of business or anticipatory profits, or consequential damages resulting from the use of these Standard Drawings. Persons must not rely on these Standard Drawings as the equivalent of, or a substitute for, project-specific design and assessment by an appropriately qualified professional.



A	APPROVED FOR USE	DEC 2020
No	Revision	Date

DRAWING NOT TO SCALE		Drawing Title	BIKE HOOP
Approved	Project Services	Original Size	A3
Date	Dec. 2020	Drawing No:	CPP4101
			Rev: A