

SKETCH OF LAND SEARCHED

AP 80067

Land Searched

Parish: MELBOURNE SOUTH.

Town: _____

Section _____

Crown Allotment: Whole / Part . 39.

Crown Portion: Whole / Part _____

Last Registered Owners

Book 52 No. 00A

Encumbrances (other than easements)

Mortgage Book _____ No. _____

Mortgage Book _____ No. _____

Mortgage Book _____ No. _____

Covenant Book _____ No. _____

Charge Book _____ No. _____

Notices Book _____ No. _____

Other Book _____ No. _____

Easements (Encumbering or Appurtenant)

Easement Reference eg: E-1, A-1	Purpose / Authority	Width	Origin Book No.	Land benefited / In favour of (If apparent from search)
NIL				

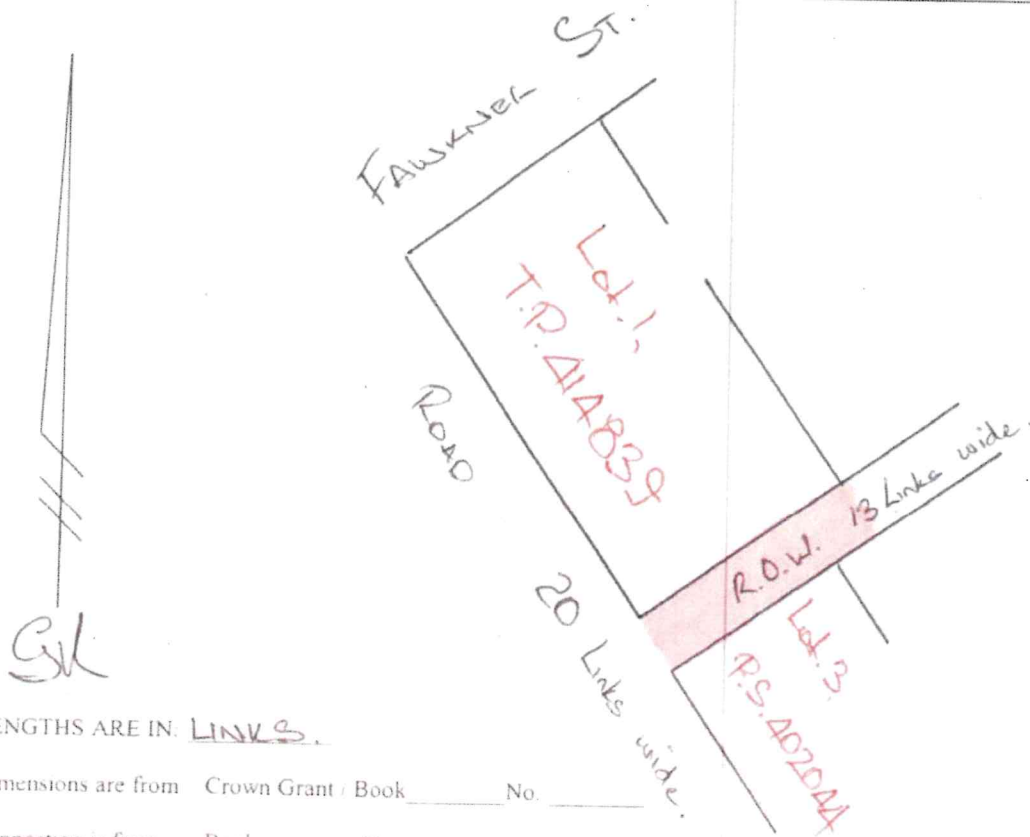

LENGTHS ARE IN: LINKS.

Dimensions are from Crown Grant / Book _____ No. _____

Connection is from Book _____ No. _____

Note to Legal Practitioners

(Taken from Schedule 5A Transfer of Land Act) Where the land includes rights of appurtenance, abuttal, etc. justified in any deed which forms part of a separate chain of title, a photocopy of the deed, certified by the Legal Practitioner making the certificate, must be produced. That chain of title must also be produced, except those parts which have been accepted by the Registrar under a prior conversion.

GH