

**SEATING - EXISTING PAVING  
FRONT ELEVATION**

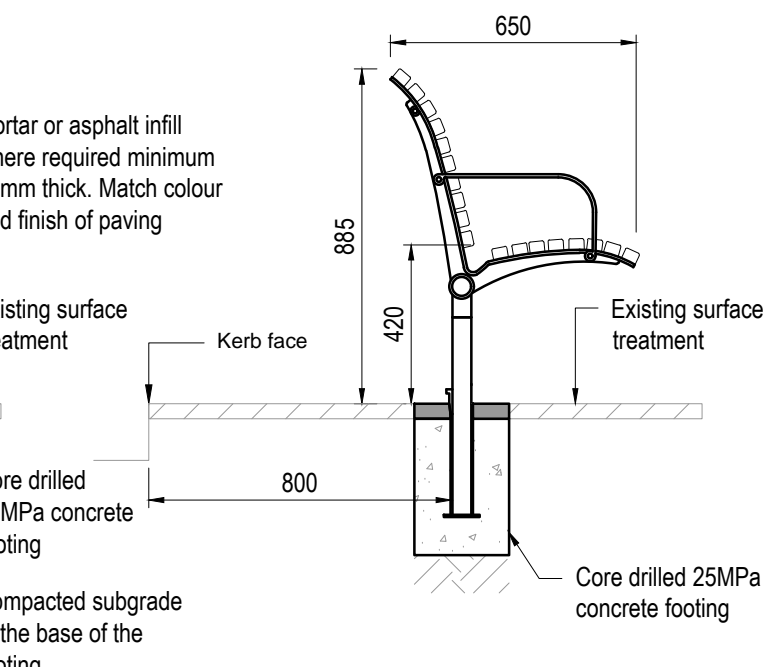

**SEATING - EXISTING PAVING  
SIDE ELEVATION**

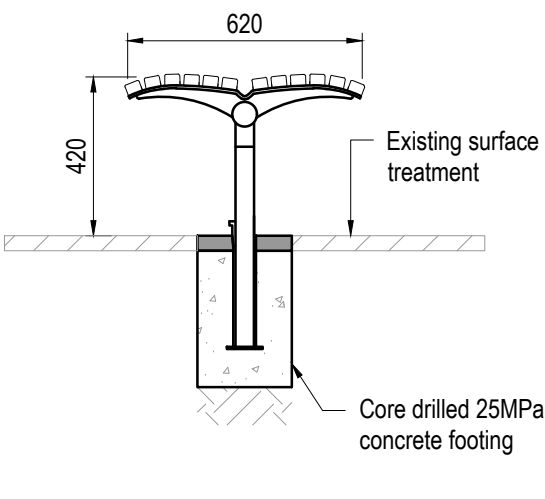

**BEACH SEATING - EXISTING PAVING  
SIDE ELEVATION**

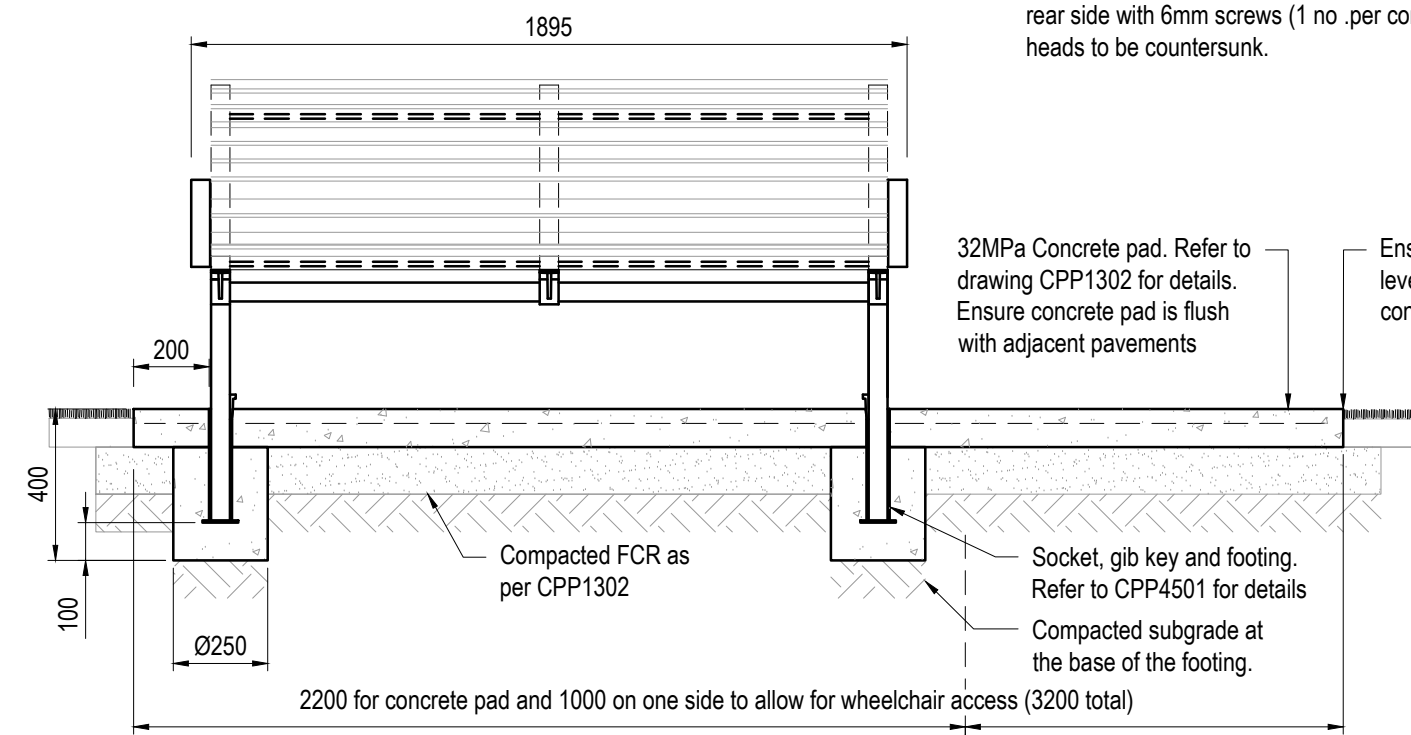

**SEATING - IN CONCRETE PAD  
FRONT ELEVATION**

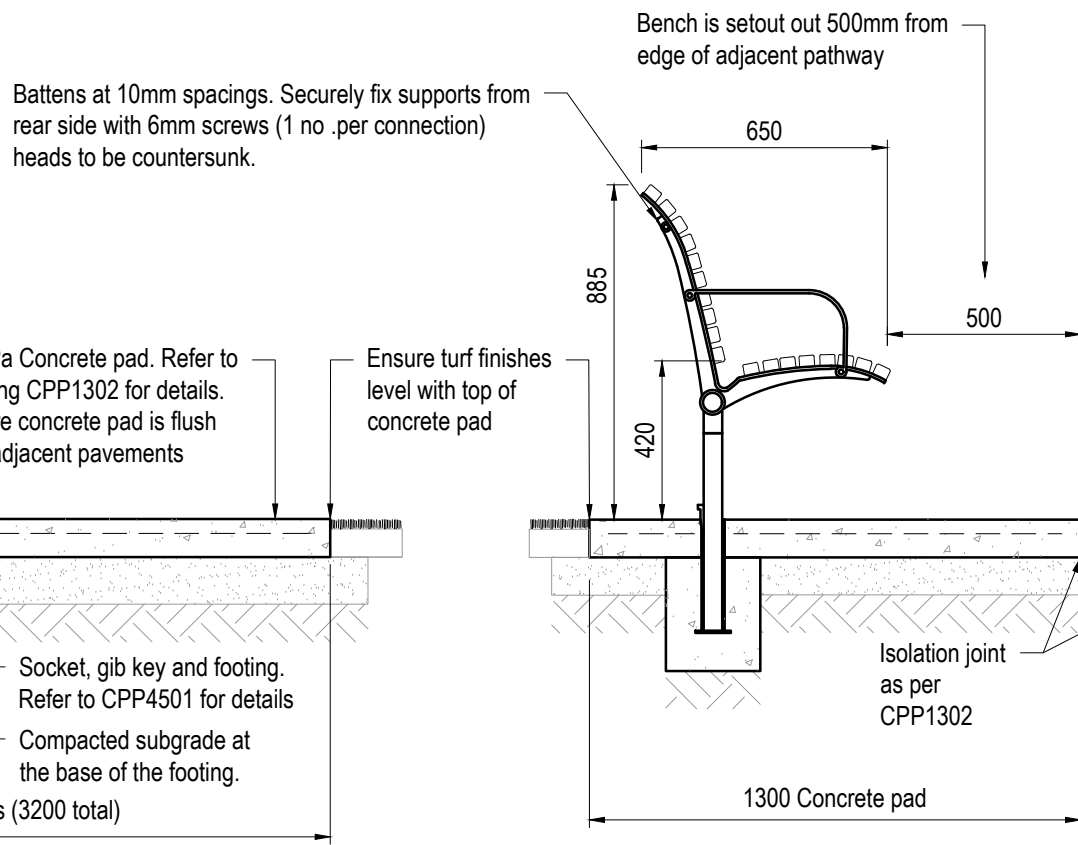

**SEATING - IN CONCRETE PAD  
SIDE ELEVATION**

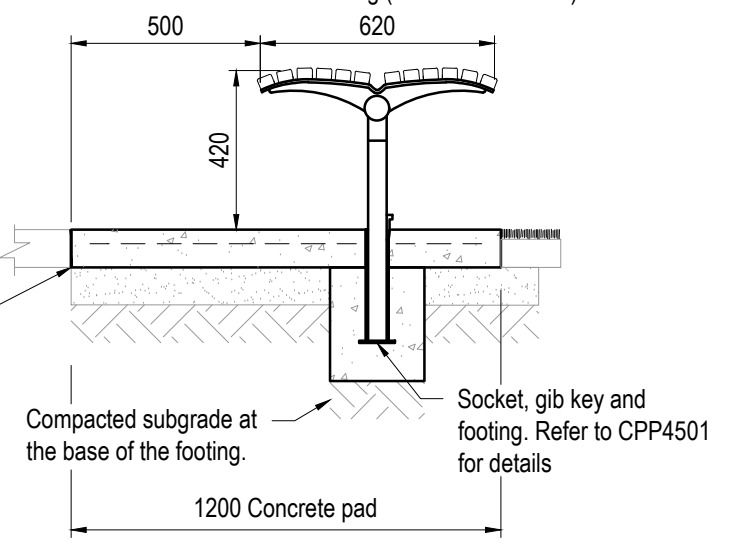

**BEACH SEATING - IN CONCRETE PAD  
SIDE ELEVATION**

**NOTES**

1. Drawing in millimetres unless noted otherwise.
2. Seats should be positioned to take advantage of summer shade, winter sun and any interesting views or activities. Seats are generally placed at a minimum of 50m intervals.
3. Council to be determine if seat is to be installed using Core Drilled or Concrete Pad footing. Typically core drilled footings are not to be used on asphalt footpaths due to potential damage.
4. Orientated towards kerb at bus and tram steps where shelters are not otherwise provided. Minimum offset of 1200mm when face towards street.
5. The seat is fabricated from grade 316 stainless steel and hardwood, recycled hardwood timber or composite battens. The seat is fixed within the pavement surface using a gib key and socket detail.
6. Bench without back should only be used in locations where a bench with back is already placed.
7. Concrete colour to match adjacent and to be 25MPa at 28 days.
8. Battens (40 x 30 x 1800, 20mm spacing typ.) to be approved type & material. Timber battens to be of first quality, straight grained, free of splits, gum veins or splinters. All exposed edges to 3mm chamfer & sanded smooth. An additional coat of stain & sanding may be required after installation, as instructed by CoPP.
9. For fabrication and installation details contact the City of Port Phillip.
10. Bench to be set level with an average height of 420mm when installed on a sloping surface.
11. Installation of Bike hoops to be set as least 200mm away from edge of concrete footing to edge of existing services.
12. Where excavation will occur, contractor must conduct a Dial Before You Dig ([www.1100.com.au](http://www.1100.com.au)).

A APPROVED FOR USE		DEC 2020
No	Revision	Date

**Disclaimer:**  
The authors and sponsoring organisations shall have no liability or responsibility to the user or any other person or entity with respect to any liability, loss or damage caused or alleged to be caused, directly or indirectly, by the adoption and use of these Standard Drawings including, but not limited to, any interruption of service, loss of business or anticipatory profits, or consequential damages resulting from the use of these Standard Drawings. Persons must not rely on these Standard Drawings as the equivalent of, or a substitute for, project-specific design and assessment by an appropriately qualified professional.



DRAWING NOT TO SCALE	
Approved	Project Services
Date	Dec. 2020

Drawing Title	SEATING - TIMBER SLATTED
Original Size	A3
Drawing No:	CPP4301
Rev:	A