

120 LITTER BIN ENCLOSURE ELEVATION

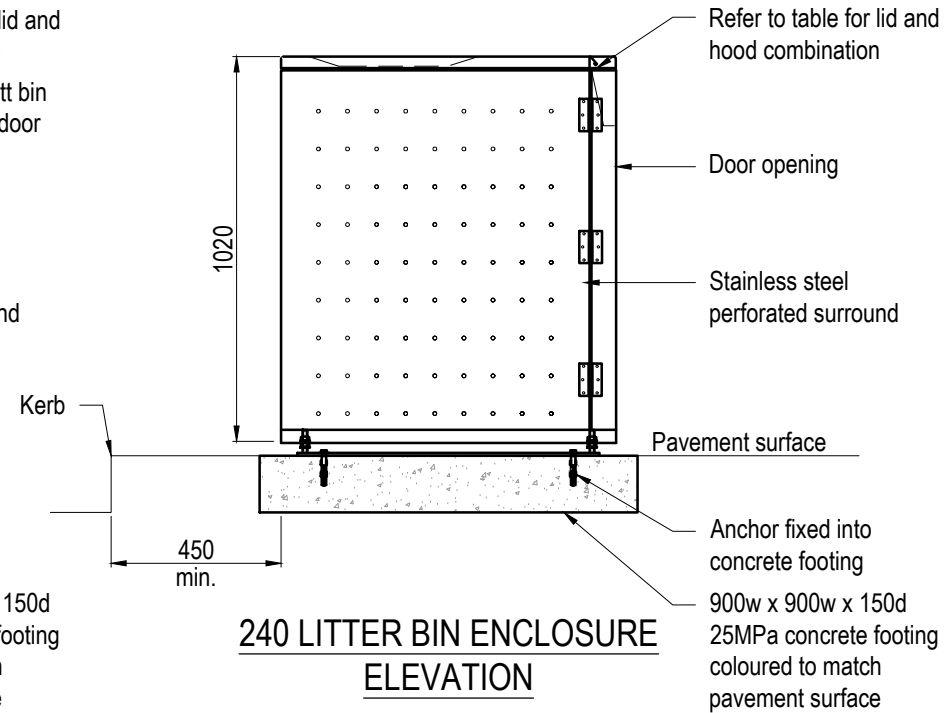

240 LITTER BIN ENCLOSURE ELEVATION

| Bin Enclosure Combination Schedule | | | |
|------------------------------------|------------------------|------------------------|------------------|
| Size | Without Hood | With Hood | With Pyramid Lid |
| | Circular Lid 290mm Dia | Circular Lid 400mm Dia | Two Holes |
| 120L | Yes | No | Yes |
| 240L | Yes | Yes | Yes |

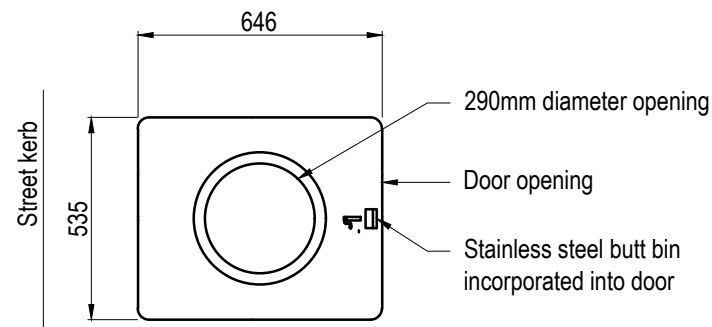

120L ENCLOSURE CIRCULAR LID (290mm DIA) PLAN

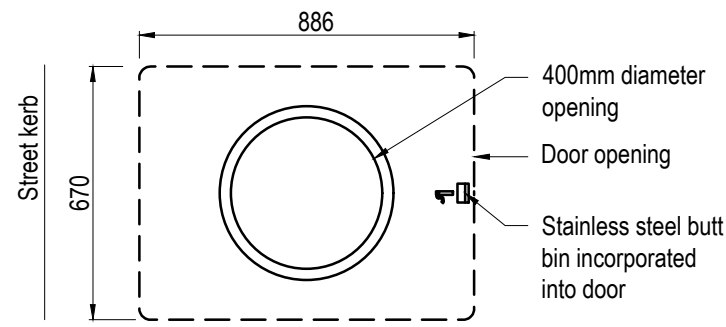

240L ENCLOSURE CIRCULAR LID (400mm DIA) PLAN

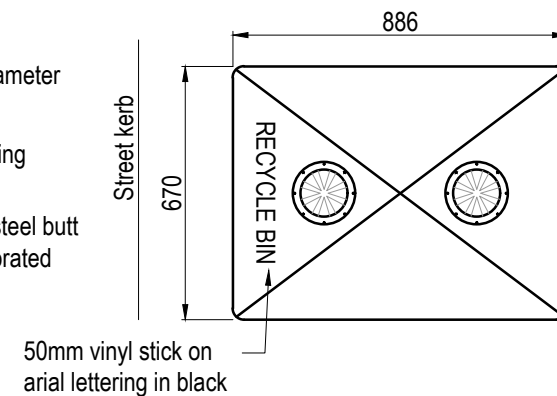

PYRAMID RECYCLE LID PLAN

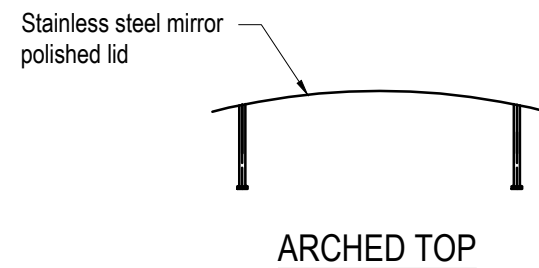

ARCHED TOP

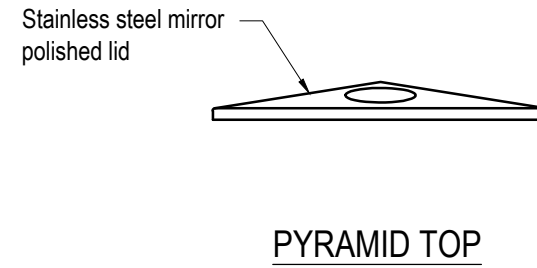

PYRAMID TOP

NOTES

1. Drawings in millimetres unless noted otherwise.
2. The city litter and recycling bins are used throughout the municipality, in areas of high pedestrian traffic. It should be placed within easy walking distance of food outlets, public transport stops or areas where people are likely to gather and consume food or drink.
3. The city litter bin will often be located in tandem with a city recycling bin adjacent to pedestrian crossing points. These city bins should be placed closest to the crossing point. Minimum gap between bins is 250mm. Bins should be placed a minimum of 450mm from the face of the kerb.
4. The enclosures are fabricated from 316 stainless steel and is serviced by a 120 liter or a 240 liter wheeled plastic bin.
5. Bins should not be located within the boarding, alighting or waiting zones of any bus or tram stop. Ensure minimum clear zone of 5 metres is preserved.
6. For fabrication and installation details contact the City of Port Phillip.
7. Door of bin enclosure should be facing footpath traffic.
8. Anchors can be fixed directly into concrete or sawn bluestone footpaths.
9. The 120L & 240L bins can be installed with stainless steel mirror polished lids only or with a hood. The hoods can be enclosed or open. In addition the 240L bin can be installed with only a stainless steel mirror polished lid for recycling purposes. Council to specify the lid combinations for the location under consideration. Refer to bin combination schedule for arrangement.

| | | |
|--------------------|----------|----------|
| A APPROVED FOR USE | | DEC 2020 |
| No | Revision | Date |

Disclaimer:
The authors and sponsoring organisations shall have no liability or responsibility to the user or any other person or entity with respect to any liability, loss or damage caused or alleged to be caused, directly or indirectly, by the adoption and use of these Standard Drawings including, but not limited to, any interruption of service, loss of business or anticipatory profits, or consequential damages resulting from the use of these Standard Drawings. Persons must not rely on these Standard Drawings as the equivalent of, or a substitute for, project-specific design and assessment by an appropriately qualified professional.



| | |
|----------------------|------------------|
| DRAWING NOT TO SCALE | |
| Approved | Project Services |
| Date | Dec. 2020 |

| | | |
|---------------|----------------|---------------------|
| Drawing Title | BIN ENCLOSURES | |
| Original Size | A3 | Drawing No: CPP4201 |
| Rev: | A | |