

ATTACHMENT 2

	PLAN OF SUBDIVISION	STAGE No. --	LRS USE ONLY EDITION	PLAN NUMBER PS 627662F
LOCATION OF LAND PARISH: MELBOURNE SOUTH CITY: PORT MELBOURNE SECTION: 7 CROWN ALLOTMENTS: 2 (PART) AND 20 (PART) CROWN PORTION: -- TITLE REFERENCES: VOL1844 FOL619; VOL8838 FOL197; VOL9254 FOL602; VOL9254 FOL603 VOL FOL LAST PLAN REFERENCE: TP159566V; TP165329B & TP907616Q POSTAL ADDRESS: 121 LIARDET STREET (at time of subdivision) PORT MELBOURNE MGA CO-ORDINATES: E: 318960 ZONE: 55 (of approx. centre of plan) N: 5810030 DATUM: GDA 94		COUNCIL CERTIFICATION AND ENDORSEMENT COUNCIL NAME: PORT PHILLIP CITY COUNCIL REF: 1. THIS PLAN IS CERTIFIED UNDER SECTION 6 OF THE SUBDIVISION ACT 1988. 2. THIS PLAN IS CERTIFIED UNDER SECTION 11(7) OF THE SUBDIVISION ACT 1988. DATE OF ORIGINAL CERTIFICATION UNDER SECTION 6 3. THIS IS A STATEMENT OF COMPLIANCE ISSUED UNDER SECTION 21 OF THE SUBDIVISION ACT 1988. OPEN SPACE (i) A REQUIREMENT FOR PUBLIC OPEN SPACE UNDER SECTION 18 OF THE SUBDIVISION ACT 1988 HAS / HAS NOT BEEN MADE. (ii) THE REQUIREMENT HAS BEEN SATISFIED. (iii) THE REQUIREMENT IS TO BE SATISFIED IN STAGE COUNCIL DELEGATE COUNCIL SEAL DATE / / RE-CERTIFIED UNDER SECTION 11(7) OF THE SUBDIVISION ACT 1988 COUNCIL DELEGATE COUNCIL SEAL DATE / /		
VESTING OF ROADS OR RESERVES				
	IDENTIFIER	COUNCIL/BODY/PERSON		
	ROAD R1	PORT PHILLIP CITY COUNCIL		
NOTATIONS				
DEPTH LIMITATION DOES NOT APPLY		STAGING THIS IS NOT A STAGED SUBDIVISION PLANNING PERMIT No.		
NOTES: BOUNDARIES SHOWN BY THICK CONTINUOUS LINES ARE DEFINED BY BUILDINGS LOCATION OF BOUNDARIES DEFINED BY BUILDINGS: EXTERIOR FACE: E		ESTATE: -- STAGE: -- AREA: 961 m ² No. OF LOTS: 2 MEL: 2J :F:5 THIS IS A SPEAR PLAN FURTHER PURPOSE OF PLAN:- REMOVAL OF THE RIGHT AND TITLE POWER OVER VOL8838 FOL197 AS PROVIDED FOR IN SECTION 528 (2) (e) OF THE LOCAL GOVERNMENT ACT 1958 AUTHORITY:- DEED OF ABANDONMENT PURSUANT TO SECTION 106C OF THE TRANSFER OF LAND ACT 1958 SURVEY: THIS PLAN IS BASED ON SURVEY VIDE APPn 57050 THIS SURVEY HAS BEEN CONNECTED TO PERMANENT MARKS No(s). LAND NOT IN A PROCLAIMED SURVEY AREA		
EASEMENT INFORMATION				LRS USE ONLY
LEGEND: A - APPURTENANT E - ENCUMBERING EASEMENT R - ENCUMBERING EASEMENT (ROAD)				STATEMENT OF COMPLIANCE/ EXEMPTION STATEMENT RECEIVED <input type="checkbox"/> DATE / /
SECTION 12(2) OF THE SUBDIVISION ACT 1988 APPLIES TO LAND AND LOTS IN THIS PLAN				
EASEMENT REFERENCE	PURPOSE	WIDTH (METRES)	ORIGIN	LAND BENEFITED OR IN FAVOUR OF
(E-1)	SEWERAGE UPPER LIMIT RL(AHD)	SEE PLAN	THIS PLAN	SOUTH EAST WATER LIMITED
(E-2)	FOOTWAY UPPER LIMIT RL(AHD)	SEE PLAN	THIS PLAN	LOT 2 IN THIS PLAN
(E-3)	SEWERAGE UPPER LIMIT RL(AHD)	SEE PLAN	THIS PLAN	SOUTH EAST WATER LIMITED
(E-3)	FOOTWAY UPPER LIMIT RL(AHD)	SEE PLAN	THIS PLAN	LOT 2 IN THIS PLAN
				LRS USE ONLY PLAN REGISTERED TIME DATE / / ASSISTANT REGISTRAR OF TITLES SHEET 1 OF 5 SHEETS
 Breese Pitt Dixon Pty Ltd 1/19 Cato Street Hawthorn East Vic 3123 Ph: 8823 2300 Fax: 8823 2310 www.bpd.com.au info@bpd.com.au		LICENSED SURVEYOR: GEOFF W HUMPHREY SIGNATURE: .. DIGITALLY SIGNED. REF: 7762		DATE / / COUNCIL DELEGATE SIGNATURE ORIGINAL SHEET SIZE A3
CHECKED	JE	DATE: 14/01/10		
		VERSION: 3		

DIAGRAM 1
SITE PLAN
GROUND LEVEL
AND GROUND FLOOR

PLAN OF SUBDIVISION

STAGE No.

PLAN NUMBER

--

PS 627662F

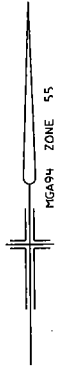

TYPICAL ENLARGEMENT
(NOT TO SCALE)

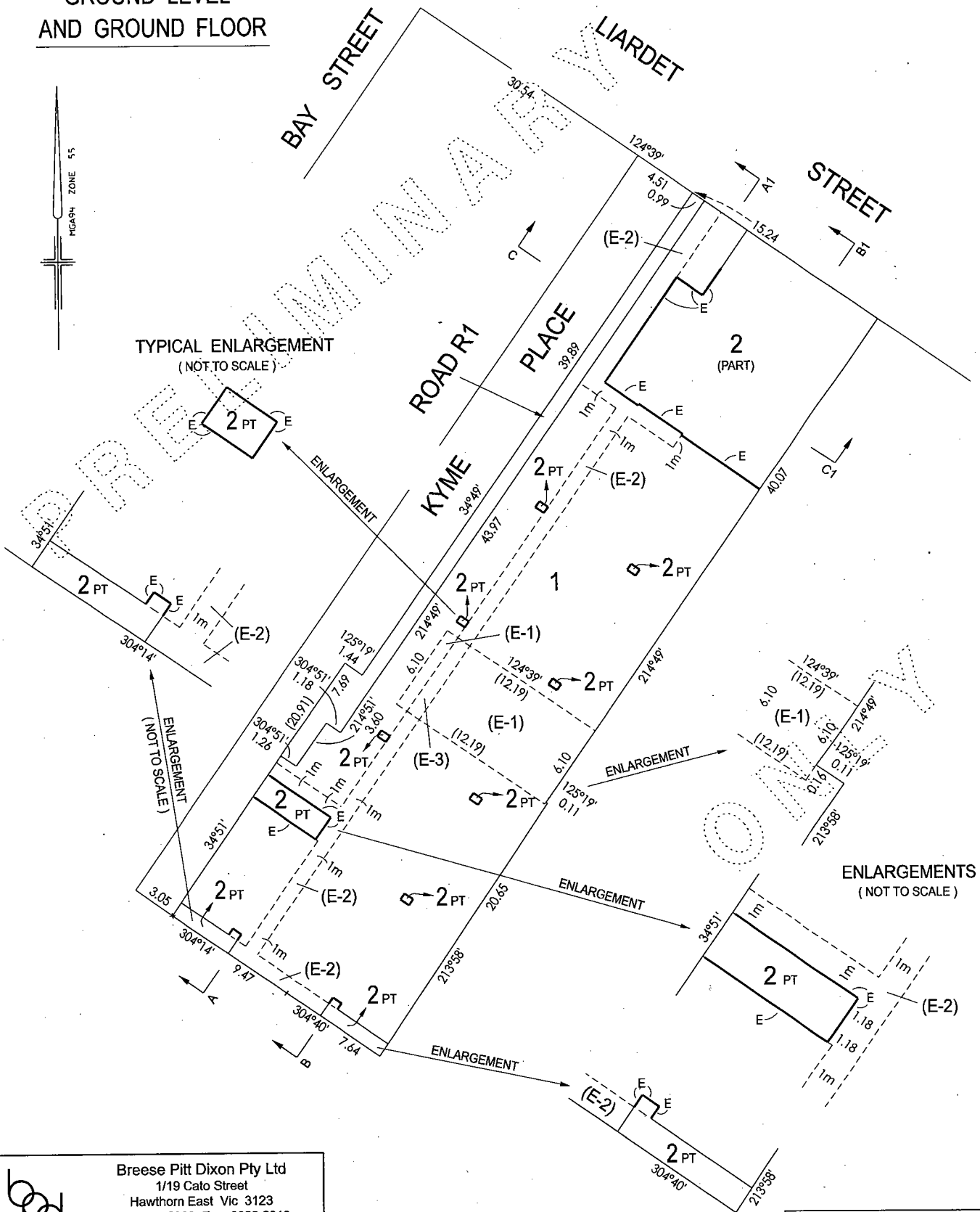
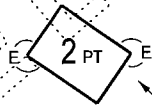

ENLARGEMENTS
(NOT TO SCALE)



Breese Pitt Dixon Pty Ltd
1/19 Cato Street
Hawthorn East Vic 3123
Ph: 8823 2300 Fax: 8823 2310
www.bpd.com.au info@bpd.com.au

SHEET 2

ORIGINAL

SCALE

LICENSED SURVEYOR: GEOFF W HUMPHREY

SHEET SCALE
SIZE A3 1:250

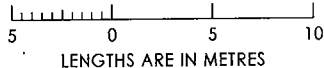

SIGNATURE: DIGITALLY SIGNED

REF: 7762

VERSION: 3

DATE / /
COUNCIL DELEGATE SIGNATURE

DIAGRAM 2
FIRST FLOOR
AND ABOVE

PLAN OF SUBDIVISION

STAGE No.

--

PLAN NUMBER

PS 627662F

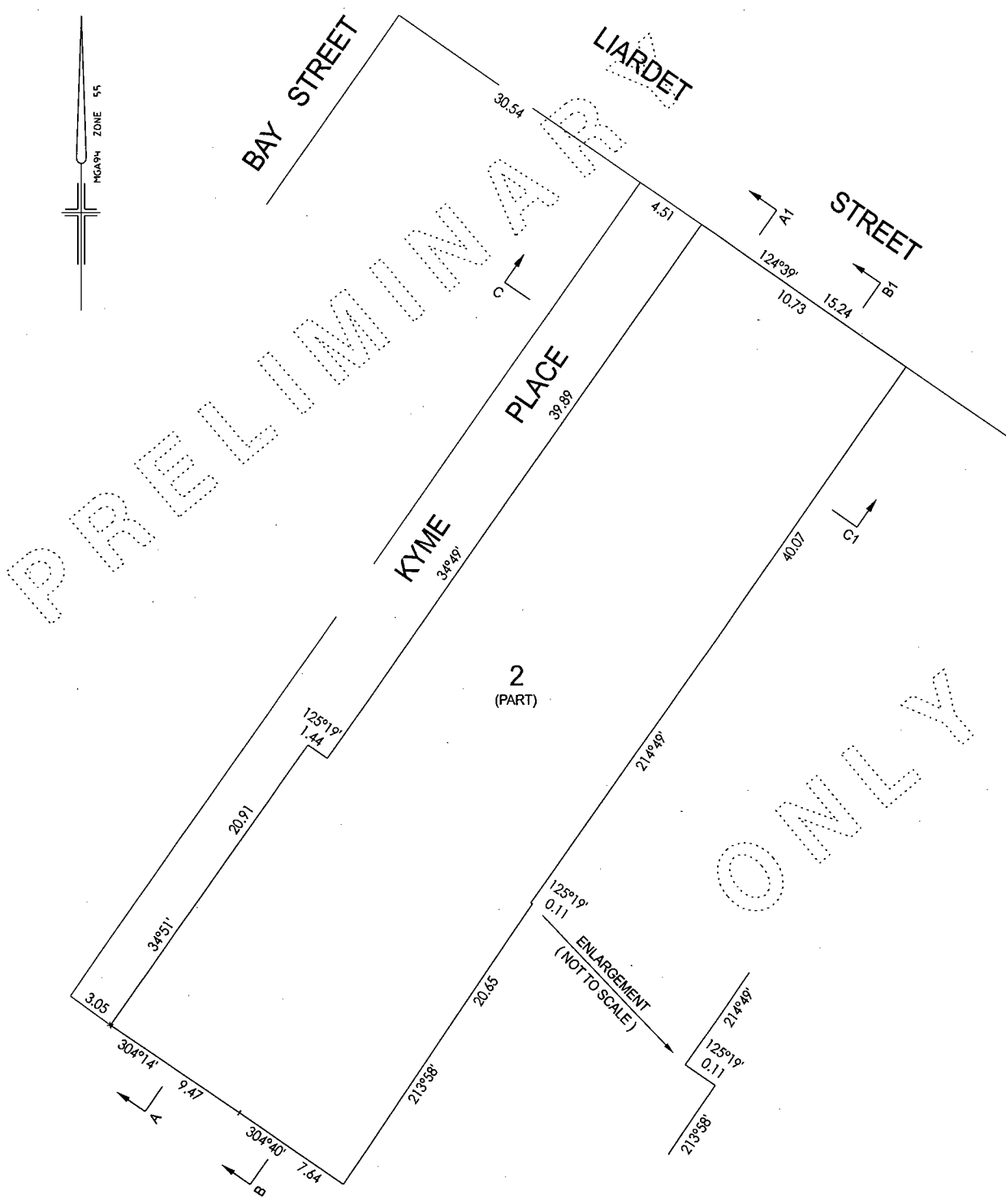
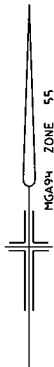

Breese Pitt Dixon Pty Ltd
1/19 Cato Street
Hawthorn East Vic 3123
Ph: 8823 2300 Fax: 8823 2310
www.bpd.com.au info@bpd.com.au

SHEET 3

ORIGINAL
SHEET SIZE
A3

SCALE

1:250

SCALE



LENGTHS ARE IN METRES

LICENSED SURVEYOR: GEOFF W HUMPHREY

SIGNATURE: DIGITALLY SIGNED

REF: 7762

VERSION: 3

DATE

COUNCIL DELEGATE SIGNATURE

PLAN OF SUBDIVISION
 STAGE No. --
 PLAN NUMBER
 PS 627662F

CROSS SECTION

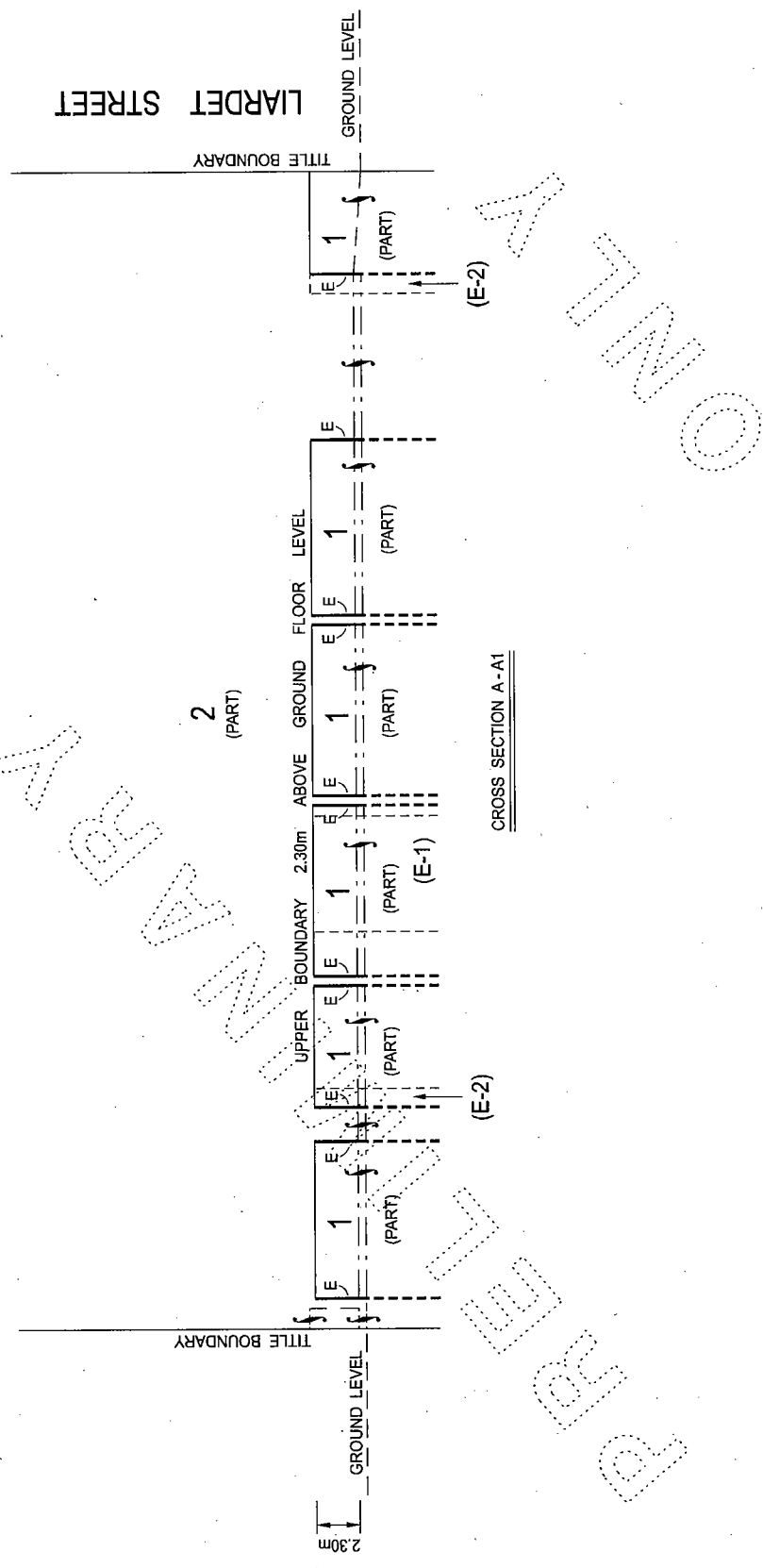

CROSS SECTION A-A1

SHEET 4
 DATE / /
 COUNCIL DELEGATE SIGNATURE

LICENSED SURVEYOR: GEOFF W HUMPHREY
 SIGNATURE: . DIGITALLY SIGNED...
 REF: 7762
 VERSION: 3

CROSS SECTION
 NOT SCALE

ORIGINAL
 SHEET SCALE
 SIZE A3

Breese Pitt Dixon Pty Ltd
 1/19 Cato Street
 Hawthorn East Vic 3123
 Ph: 8823 2300 Fax: 8823 2310
 www.bpd.com.au info@bpd.com.au

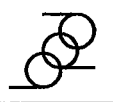

CROSS SECTIONS

PLAN OF SUBDIVISION

STAGE No. --

PLAN NUMBER
PS 627662F

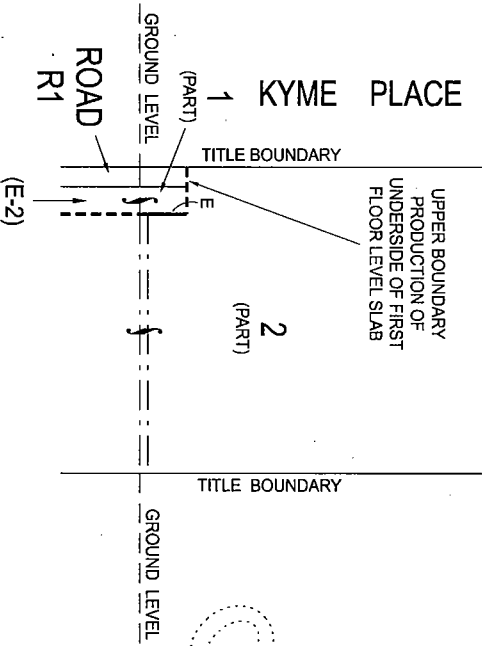
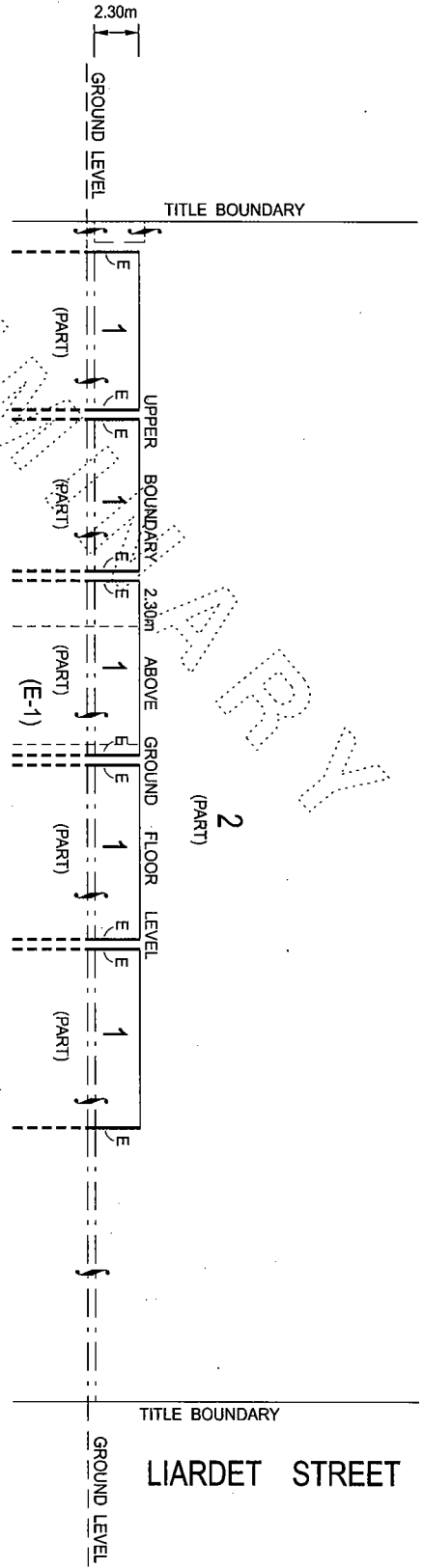

GROSS SECTION C - C1

SHEET 5

Breese Pit Dixon Pty Ltd
1/19 Calo Street
Hawthorn East Vic. 3123
Ph: 8823 2300 Fax: 8823 2310
www.bpd.com.au info@bpd.com.au

ORIGINAL
SHEET SCALE
SIZE A3

CROSS SECTIONS
NOT SCALE

LICENSED SURVEYOR: GEOFF W HUMPHREY
SIGNATURE: . DIGITALLY SIGNED...
REF: 7762

VERSION: 3

DATE / /
COUNCIL DELEGATE SIGNATURE

