

Refurbished St Kilda Family and Children's Centre

Alternative 1

Description	75 place childcare centre, 3 maternal + child health consulting rooms, 2 playgroup areas, single entry foyer.
Opinion of Probable & Estimated Cost	75 place centre only \$ 1.6 million (excl GST) Integrated entry MCH + playgroup \$500,000 (excl GST) total cost \$2.1 million (excl GST)

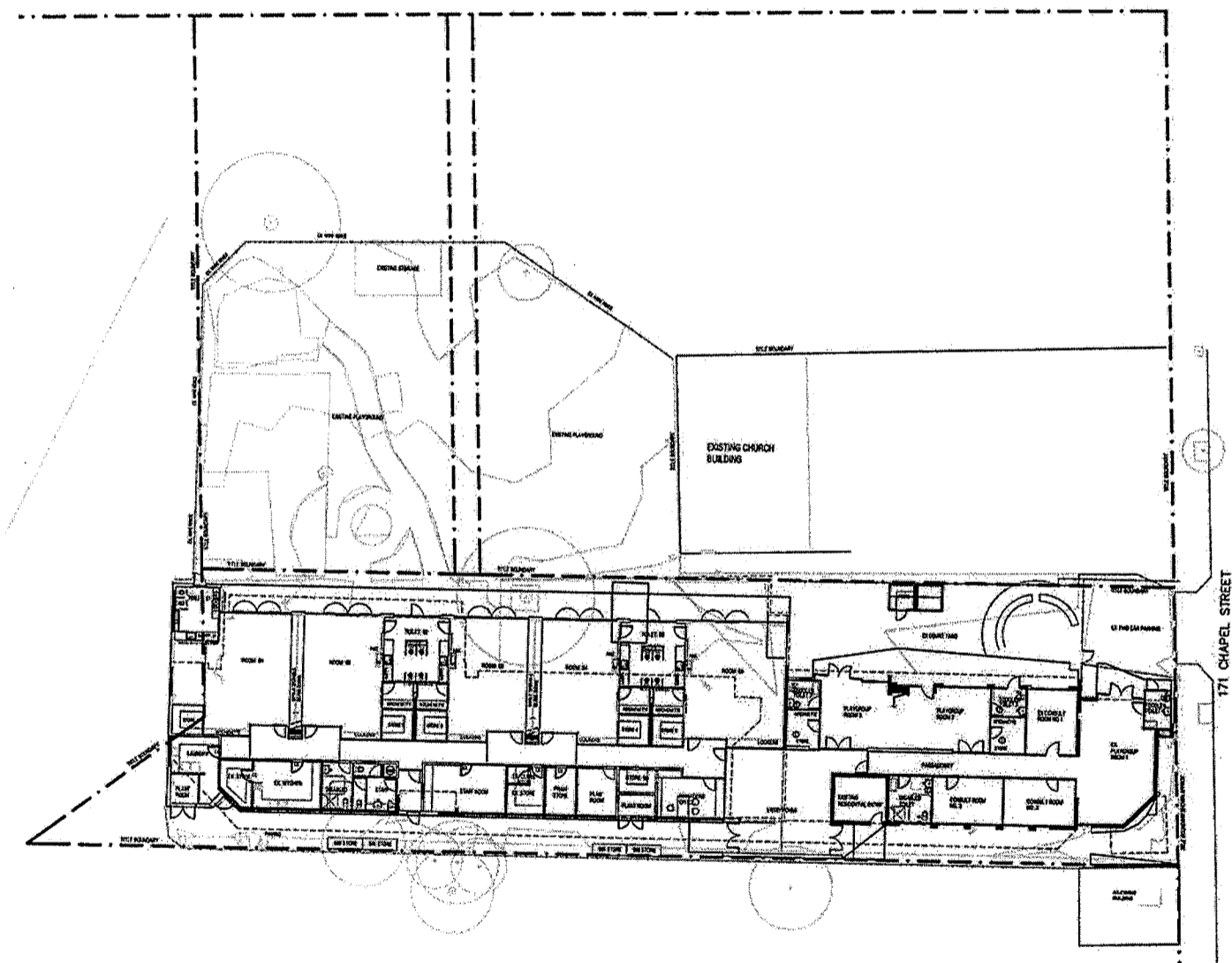

PROPOSED GROUND FLOOR PLAN

k20 architecture

325 Coventry Street
South Melbourne 3205
t: +613 9699 4440
f: +613 9699 5550



St Kilda Family and Children's Centre

Alternative 2

Description	120 place childcare centre, 3 maternal and child health consulting rooms, additional consulting suites for visiting specialists, additional playgroup facilities integrated early years and primary school programs and community spaces. No Car Park
Opinion of Probable & Estimated Cost	\$ 6.1 million (excl GST)

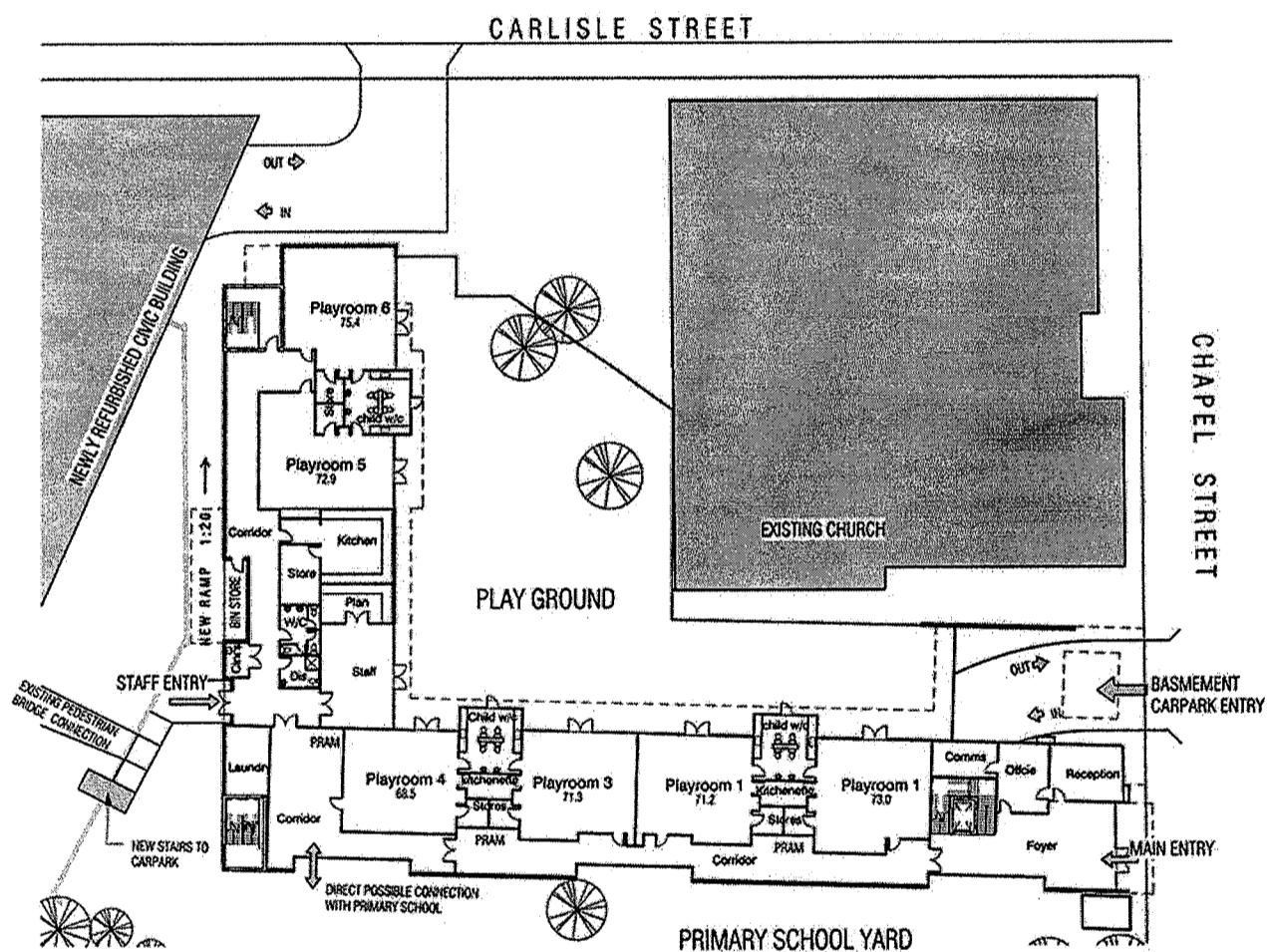

PROPOSED GROUND FLOOR PLAN

k20 architecture
 325 Coventry Street
 South Melbourne 3205
 t: +613 9699 4440
 f: +613 9699 5550



St Kilda Family and Children's Centre Alternative 2

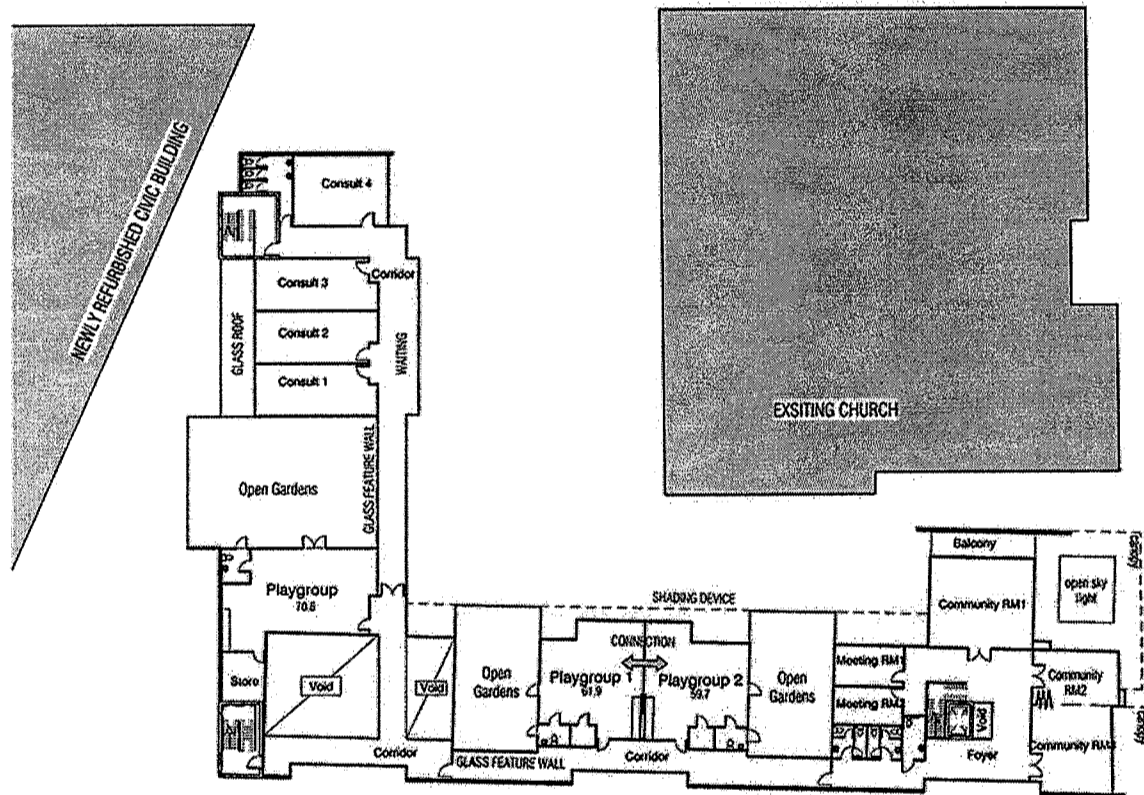

PROPOSED FIRST FLOOR PLAN

k20 architecture

325 Coventry Street
South Melbourne 3205
t: +613 9699 4440
f: +613 9699 5550



Family and Children's Centre Alternative 3

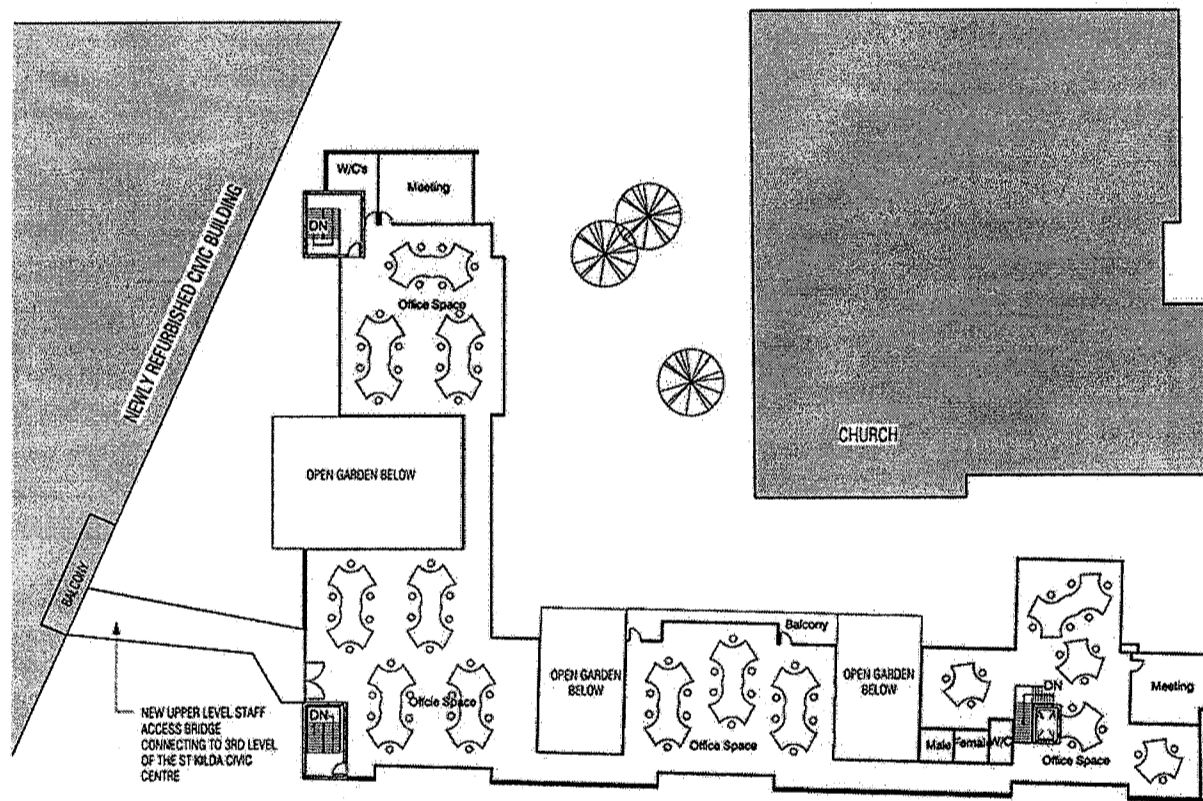

PROPOSED SECOND FLOOR PLAN

k20 architecture

325 Coventry Street
South Melbourne 3205
t: +613 9699 4440
f: +613 9699 5550



Family and Children's Centre Alternative 3

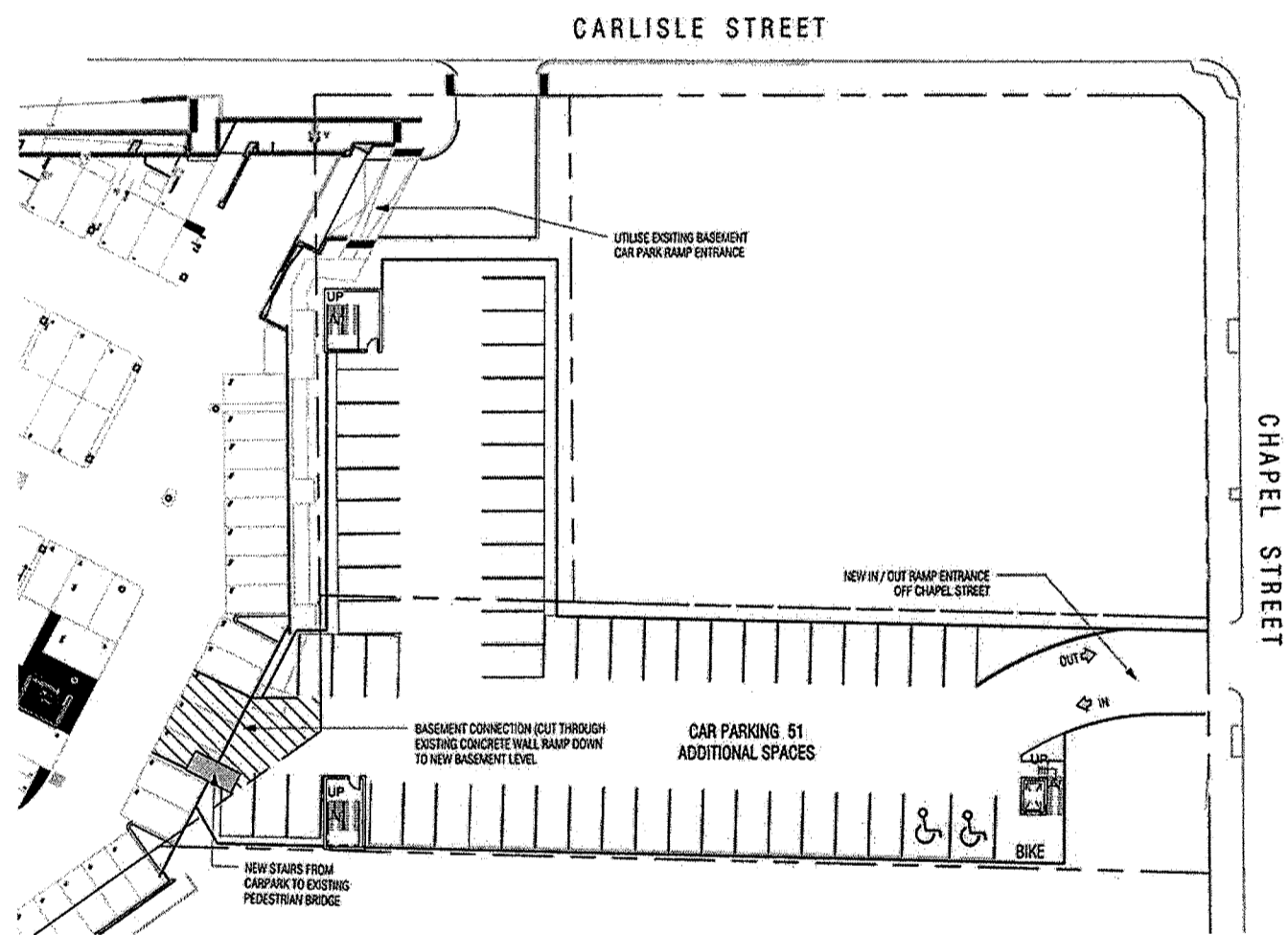

PROPOSED BASEMENT PLAN

k20 architecture

325 Coventry Street
South Melbourne 3205
t: +613 9699 4440
f: +613 9699 5550



St Kilda Family and Children's Centre

Recommended Option

Description	Basement carparking including 51 carparks, 120 place childcare centre, 3 maternal and child health consulting rooms, additional consulting suites for visiting specialists, additional playgroup facilities, integrated early years and primary school programs and community meeting spaces.
Opinion of Probable & Estimated Cost	\$ 7.0 million (excl GST)

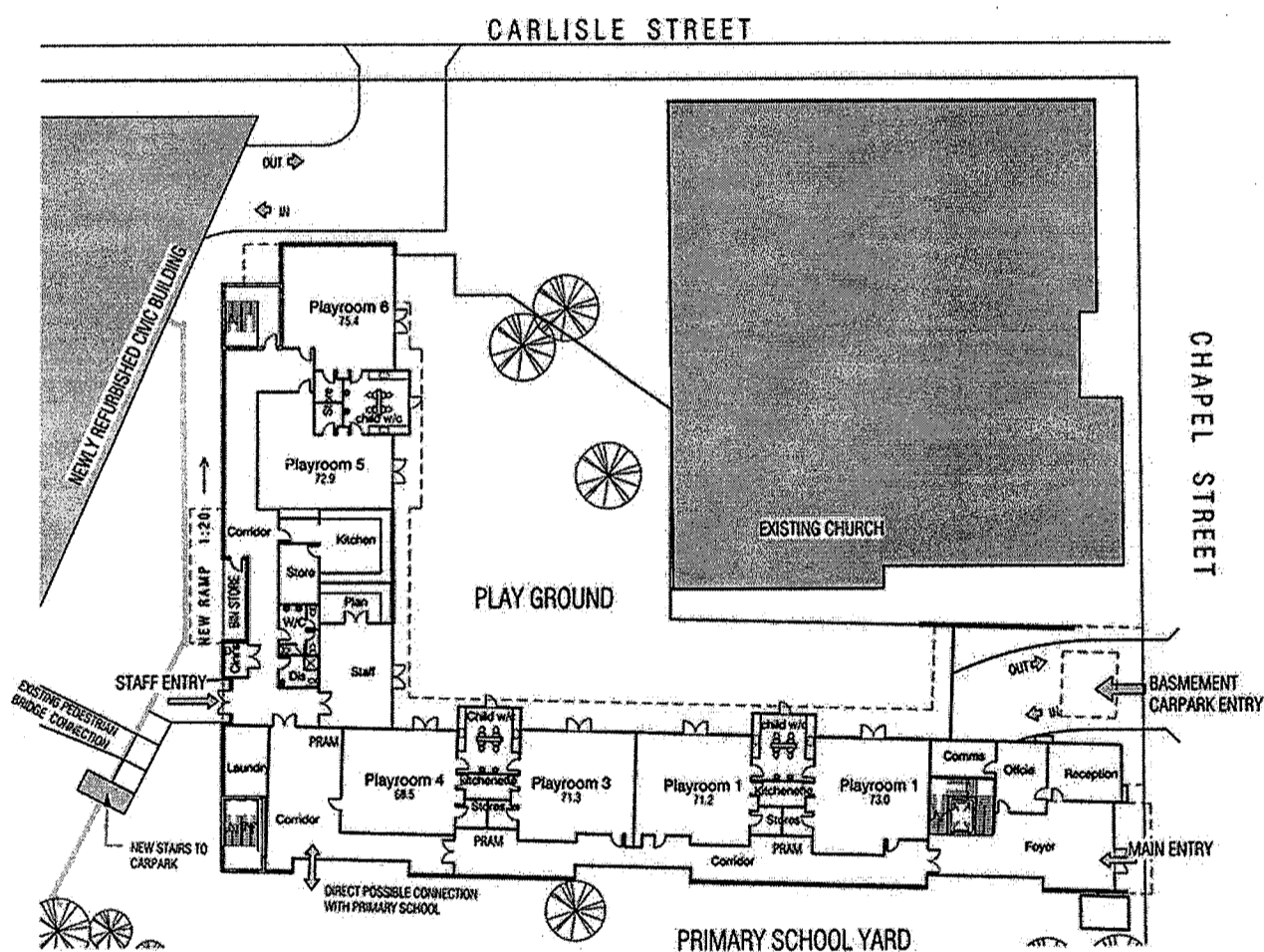

PROPOSED GROUND FLOOR PLAN

k20 architecture

325 Coventry Street
 South Melbourne 3205
 t: +613 9699 4440
 f: +613 9699 5550



St Kilda Family and Children's Centre Recommended Option

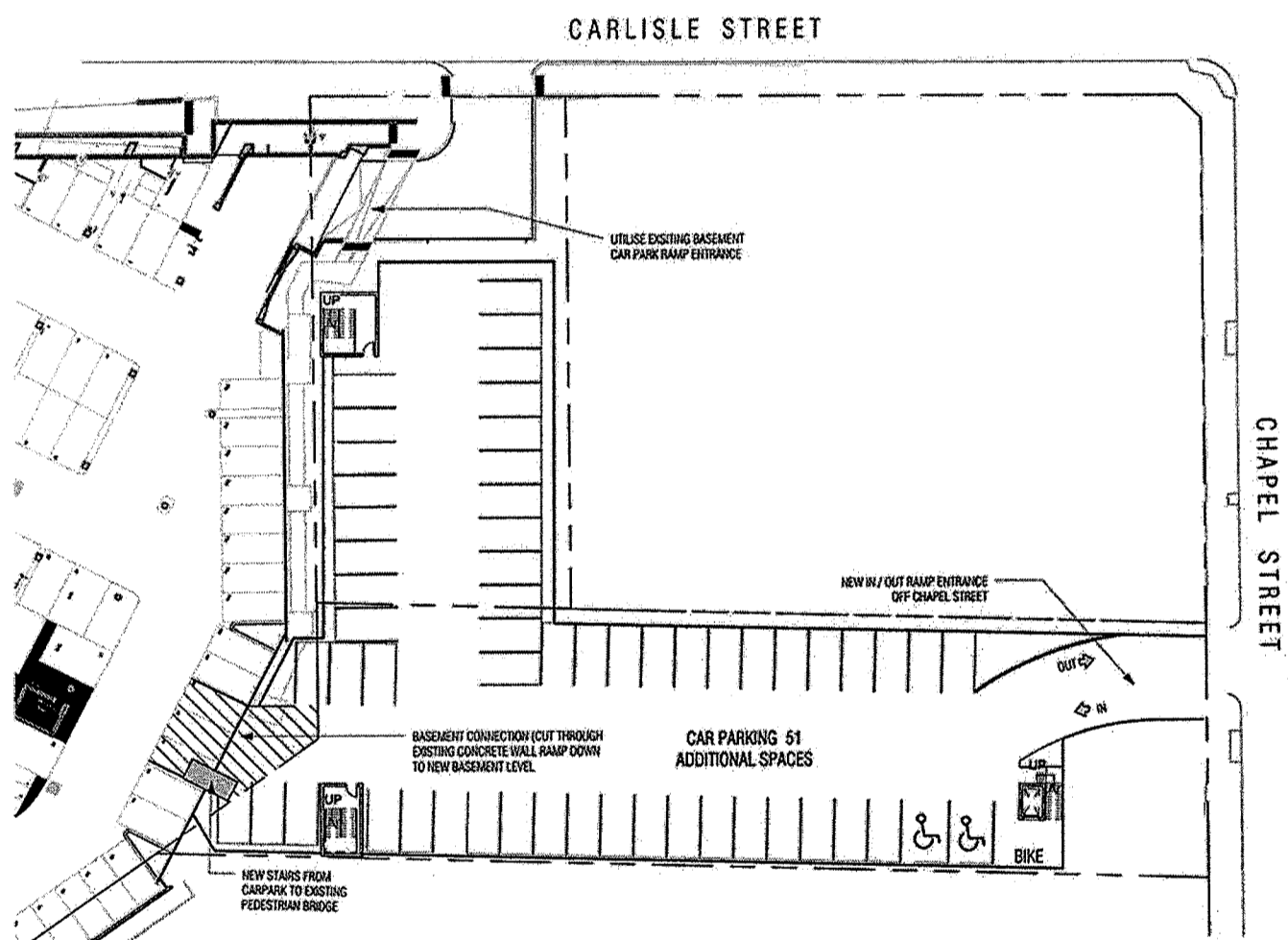

PROPOSED BASEMENT PLAN

k20 architecture

325 Coventry Street
South Melbourne 3205
t: +613 9699 4440
f: +613 9699 5550

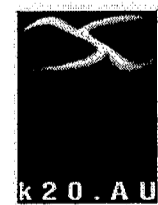

Family and Children's Centre

Alternative 3

Description	Basement carparking including 51 carparks, 120 place childcare centre, 3 maternal and child health consulting rooms, additional consulting suites for visiting specialists, additional playgroup facilities integrated early years and primary programs, community spaces and children's service administration hub.
Opinion of Probable & Estimated Cost	\$ 9.5 million (excl GST)

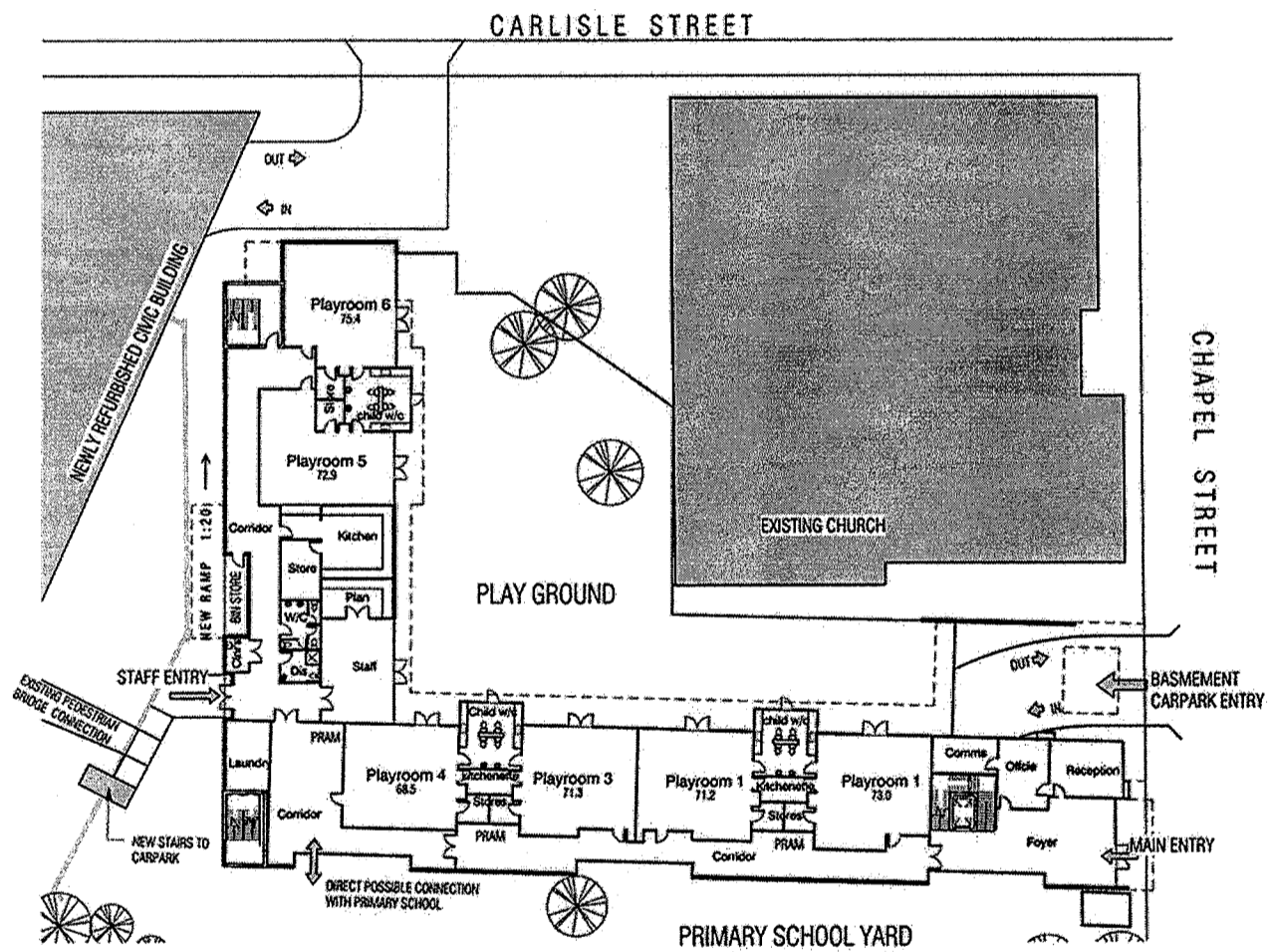

PROPOSED GROUND FLOOR PLAN

k20 architecture 325 Coventry Street
 South Melbourne 3205
 t: +613 9699 4440
 f: +613 9699 5550



Family and Children's Centre Alternative 3

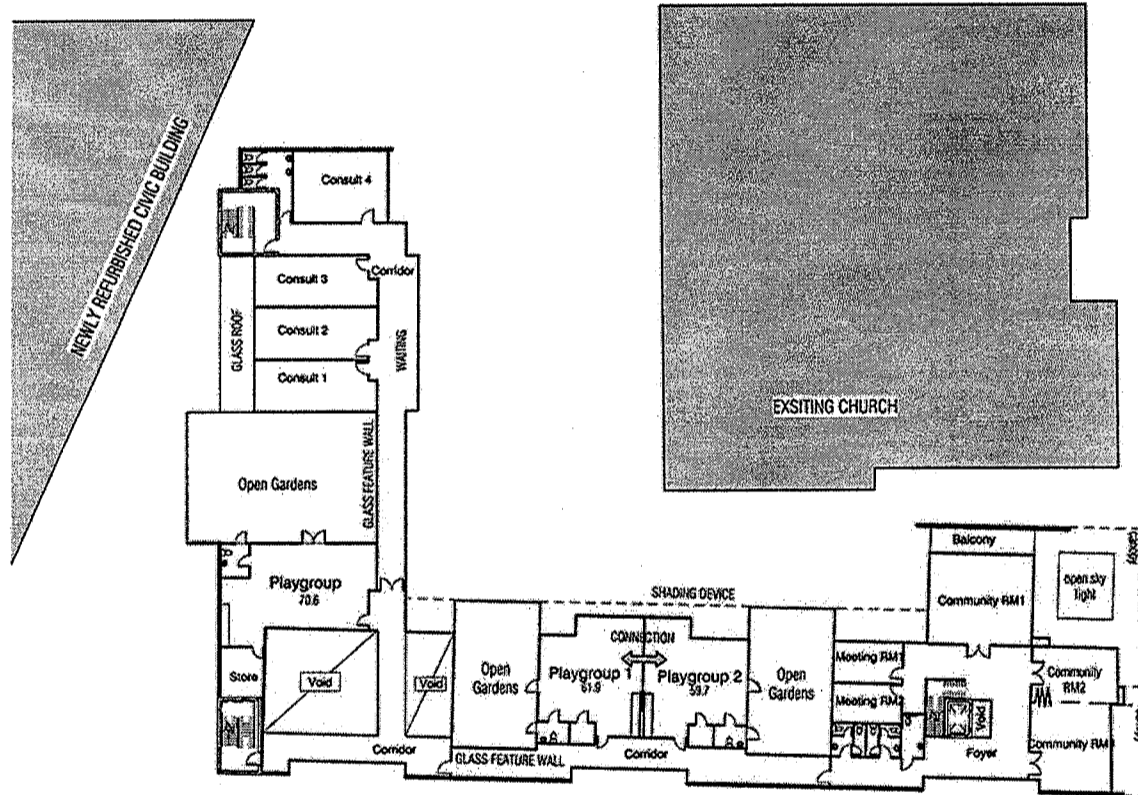

PROPOSED FIRST FLOOR PLAN

k20 architecture

325 Coventry Street
South Melbourne 3205
t: +613 9699 4440
f: +613 9699 5550



Existing Children's Centre and Adjoining M&CH Alternative 4

Description	50 place childcare centre, 2 maternal and child health consulting rooms, playgroup facility.
Opinion of Probable & Estimated Cost	\$ nil

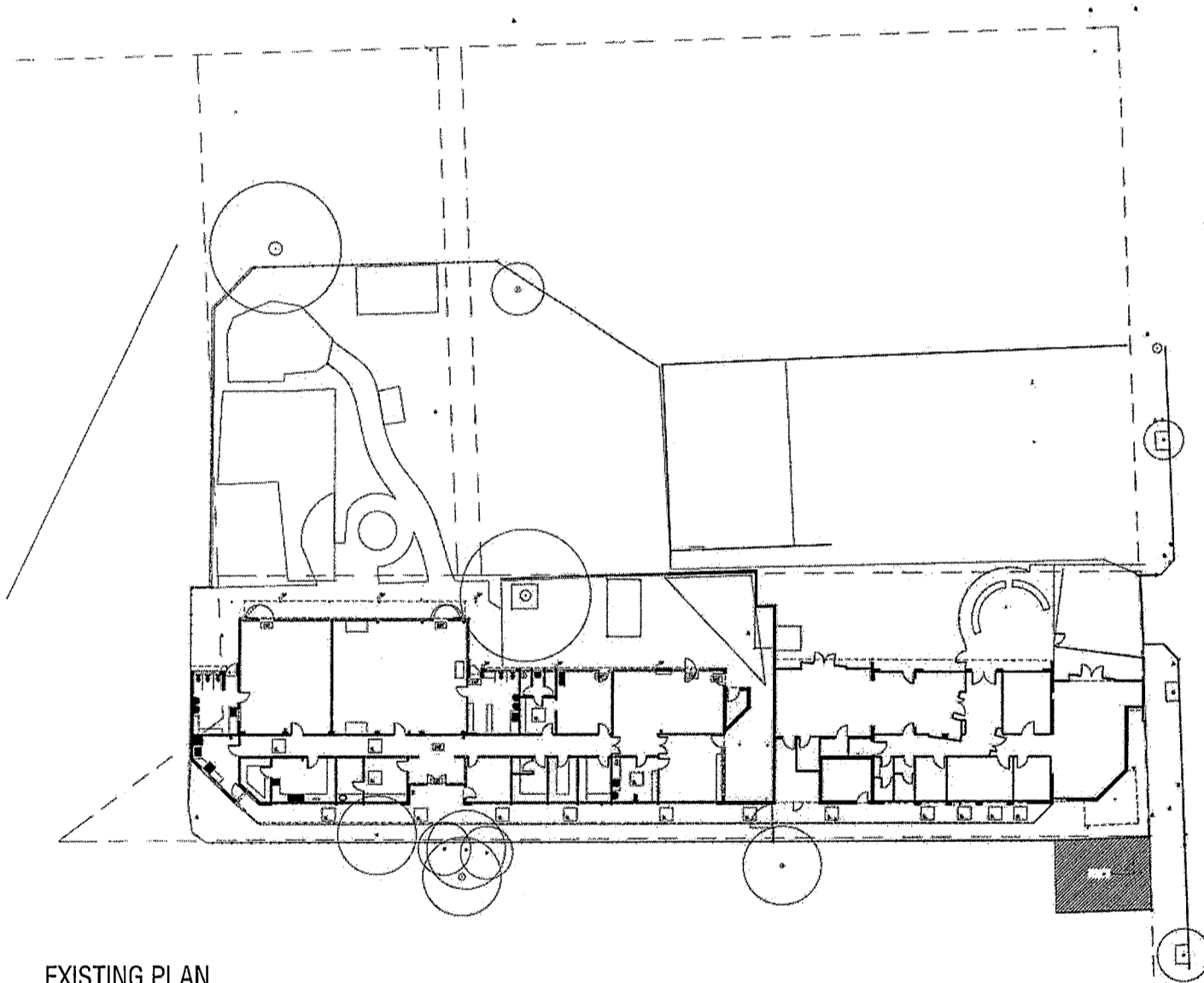

EXISTING PLAN

k20 architecture

325 Coventry Street
South Melbourne 3205
t: +613 9699 4440
f: +613 9699 5550



