

**ATTACHMENT 4**  
**DESIGN DETAIL OF POWERBOX FRONTING NO 7 FITZROY STREET**

These designs, plans and specifications and the copyright therein are the property of TRACT CONSULTANTS PTY LTD. and must not be used, reproduced or copied, wholly or in part, without the written permission of TRACT CONSULTANTS PTY LTD.

**GENERAL NOTES**

1. ALL SETOUTS AND LEVELS MUST BE CHECKED AND APPROVED ON SITE BY THE SUPERINTENDENT PRIOR TO CONSTRUCTION.
2. ANY DISCREPANCIES MUST BE REPORTED IMMEDIATELY TO THE SUPERINTENDENT.
3. DO NOT SCALE DRAWINGS. FIGURED DIMENSIONS HAVE PREFERENCE OVER SCALED DIMENSIONS.
4. THESE DRAWINGS ARE TO BE READ IN CONJUNCTION WITH THE DETAILS, SPECIFICATIONS AND ENGINEERING DOCUMENTS.
5. PROVIDE COMPREHENSIVE SHOP DRAWINGS FOR ALL FABRICATED ITEMS, FOR APPROVAL BY THE SUPERINTENDENT PRIOR TO FABRICATION.
6. LOCATE AND PROTECT ALL UNDERGROUND SERVICES PRIOR TO ANY EXCAVATION. MAKE GOOD ALL DAMAGE TO EXISTING WORKS CAUSED BY THE ACTIVITY OF THESE WORKS.
7. PROTECT FROM DAMAGE ALL EXISTING TREES, FENCES, BUILDINGS, OTHER STRUCTURES AND SITE FURNITURE.
8. ALL CONSTRUCTION TO BE IN ACCORDANCE WITH ALL RELEVANT AUSTRALIAN STANDARDS, INCLUDING ALL REVISIONS, COUNCIL REQUIREMENTS, AND INDUSTRY STANDARDS FOR METHODS AND QUALITY OF CONSTRUCTION.
9. DURING CONSTRUCTION, THE CONTRACTOR SHALL BE RESPONSIBLE FOR MAINTAINING ALL STRUCTURES AND WORKS IN A STABLE CONDITION AND SHALL ENSURE NO PARTYWILL BE OVERSTRESSED DURING CONSTRUCTION.
10. ALL SHRUBS ARE TO BE EVENLY SPACED. SETOUT OF ALL PLANT MATERIAL TO BE APPROVED.

**ADDITIONAL NOTES**

1. MOVEMENT AND CONTROL JOINTS TO ENGINEERS DETAILS. SAW CUT CONTROL JOINTS AT MAX. 6m. EXPANSION JOINTS AT 30m. PAVING JOINTS AND SAW CUT PAVING PATTERNS TO ALIGN WITH CONTROL JOINTS.
2. FOR LIGHTING, REFER TO LIGHTING DESIGN PLAN.
3. TRAM STOP DESIGN REFER TO ENGINEERING DESIGN PACKAGE.
5. SERVICE PIT LIDS TO BE REPLACED. COLOUR TO MATCH SURROUNDING PAVEMENT, TO ENGINEERS DETAILS.
6. TACTILE INDICATORS SUBJECT TO FURTHER DISCUSSION.

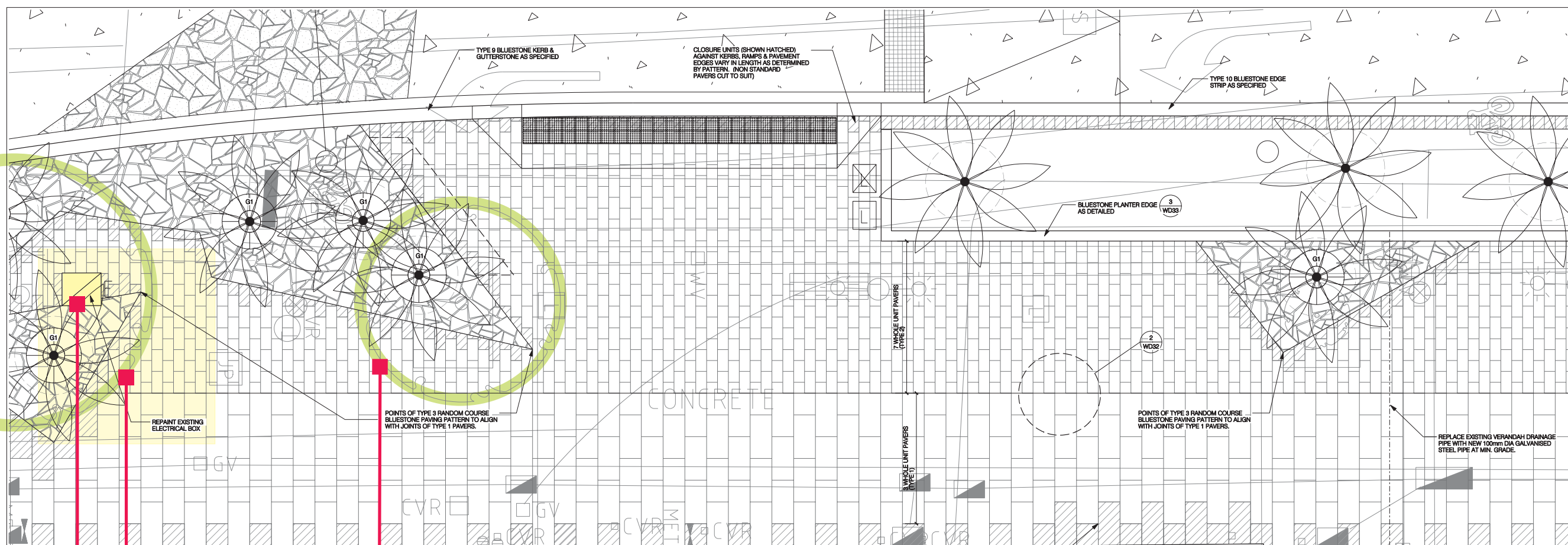

Trees to be removed  
Existing Electrical Box

BAR SANTO LAIKA MALIBU FRITZ GELATO BEACH CELLERS ELBO

**LEGEND**

<p><b>TYPE 1 - PRECAST CONCRETE PAVERS</b> Precast concrete unit pavers, 495 x 495mm x 50 nom, on 25mm mortar on reinforced concrete slab to engineers details.</p>	<p><b>TYPE 5 - BLUESTONE PAVERS</b> Sawn bluestone pavers, 295 x 295mm, on 25mm mortar on reinforced concrete slab to engineers details.</p>	<p><b>TYPE 9 - BLUESTONE KERB &amp; GUTTERSTONE</b> 300x300mm MCC style sawn bluestone non-mountable kerb as specified (150mm above finished surface). 250x100mm MCC style gutter stone as specified.</p>	<p><b>TYPE 14 - ASPHALT PAVING</b> Asphalt paving to engineers details</p>	<p><b>TYPE 20 - STONE STEPS</b> 450mm wide sawn harcourt granite steps</p>	<p><b>PHOENIX CANARIENSIS</b></p>
<p><b>TYPE 2 - PRECAST CONCRETE PAVERS</b> Precast concrete unit pavers, 495 x 245mm x 50 nom, on 25mm mortar on reinforced concrete slab to engineers details.</p>	<p><b>TYPE 6 - GRANITE PAVING</b> Natural finish Harcourt grey granite paving, 90x90mm x 80mm, on 25mm mortar on concrete slab to eng. details.</p>	<p><b>TYPE 10 - BLUESTONE EDGE STRIP</b> 300x300mm MCC style sawn bluestone edge strip as specified. Edge strip flush with adjoining surfaces.</p>	<p><b>TYPE 15 - PLAIN INSITU CONCRETE</b> Plain insitu concrete paving to engineers details. Note: pattern to match adjoining pavement as specified.</p>	<p><b>TYPE 21 - MEXPHALTE C ASPHALT</b> Mexphalt C Asphalt with transparent binder and chromans aggregate to engineers specification</p>	<p><b>WASHINGTONIA ROBUSTA</b> Trees in 3 sizes.</p>
<p><b>TYPE 3 - RANDOM COURSE BLUESTONE IN PEDESTRIAN AREAS</b> Random course bluestone paving, nom. 100-700mm stone modules, 40mm thick, on 25mm mortar on reinforced concrete slab to engineers details.</p>	<p><b>TYPE 7 - INSITU CONCRETE PAVING</b> Insitu concrete paving.</p>	<p><b>TYPE 11 - CONCRETE EDGE STRIP</b> 150x200mm concrete edge strip on as specified. Edge strip flush with adjoining surfaces.</p>	<p><b>TYPE 16 - GRANITIC SAND</b> 50mm cement stabilised granitic sand over crushed rock base to engineers details.</p>	<p><b>GROUND COVER PLANTING</b> Low groundcover planting as specified.</p>	<p><b>STANDARD RECYCLING BIN</b> (To City of Port Phillip Standards)</p>
<p><b>TYPE 4 - RANDOM COURSE BLUESTONE IN VEHICULAR AREAS</b> Random course bluestone paving, nom. 100-300mm stone modules, 60mm thick, on 25mm mortar on reinforced concrete slab to engineers details.</p>	<p><b>TYPE 8 - SAND BLASTED CONCRETE</b> Sand blast existing concrete tram line paving. Saw cut edge lines in paving to pattern as shown.</p>	<p><b>TYPE 12 - CONCRETE KERB</b> 150mm Concrete Kerb to engineers details.</p>	<p><b>TYPE 17 - RESIN BONDED AGGREGATE</b> Nom. 1200mm dia., 60mm thick resin bonded aggregate with 12mm NS basalt aggregate as specified.</p>	<p><b>STAINLESS STEEL BOLLARDS</b> Removable brushed stainless steel bollards, 900mm high, 150mm dia. as specified.</p>	<p><b>STANDARD BIKE HOOP</b> (To City of Port Phillip Standards)</p>
		<p><b>TYPE 13 - EXISTING CONCRETE</b> Existing plain concrete tram line paving.</p>	<p><b>TYPE 18 - TACTILE INDICATORS</b> Stainless steel buttons, laid in grid pattern as specified</p>	<p><b>EXISTING PIT LIDS</b> Replace existing pit lids &amp; colour match to surrounding pavement.</p>	<p><b>TREE GRATE 1 - G1</b> 1200mm dia. tree grate with nom. 600mm opening with black coating as specified.</p>
				<p><b>STANDARD SEAT (WITH BACK)</b> (To City of Port Phillip Standards)</p>	<p><b>TREE GRATE 2 - G2</b> 1800mm dia. tree grate with nom. 800mm opening with black coating as specified.</p>
				<p><b>STANDARD BIN</b> 120L Bin with smokers butt-out inlet (To City of Port Phillip Standards)</p>	

**CONSTRUCTION ISSUE**

Rev.	Description	Date	Drawn	Checked	Approved
3	CONSTRUCTION ISSUE	14/10/25	ES	M.R.	
2	TENDER ISSUE	28/07/25	ES	M.R.	
1	DRAWN / REVISION TENDER ISSUE	15/07/25	ES	M.R.	
0	DRAWN TENDER ISSUE	08/07/25	ES	M.R.	

TRACT CONSULTANTS PTY LTD  
ACN 065 213 942  
186 LENNIX STREET, RICHMOND  
VICTORIA, AUSTRALIA  
PO BOX 181 RICHMOND  
VICTORIA 3121 AUSTRALIA  
TELEPHONE 03 9429 6153  
FACSIMILE 03 9429 5925  
E-mail melbourne@tract.net.au

Client  
CITY OF PORT PHILLIP

**ST KILDA FORESHORE CONNECTIONS SURFACE TREATMENT DETAIL PLAN 8**

Drawn	Checked	Approved	Scale	Date
ES	M.R.	RTW	1:50	08.07.08

Project Number / Drawing Number  
307249 LD-WD-20

Revision  
3

F:\C:\007\307249 ST Kilda Foreshore Connections\Sheet files - WD307249 LD-WD-20.dwg 4:18:38 PM 15/10/2025