



Area of Lower Esplanade to be converted to a two-way roadway

Area of Lower Esplanade to be closed

33

27.56 m  
333.6°

Jacka Blvd  
Jacka Blvd

The Palais

Cavell St

Cavell St

Carlisle St

Luna Park / The Esplanade (St Kilda)

Luna Park

Luna

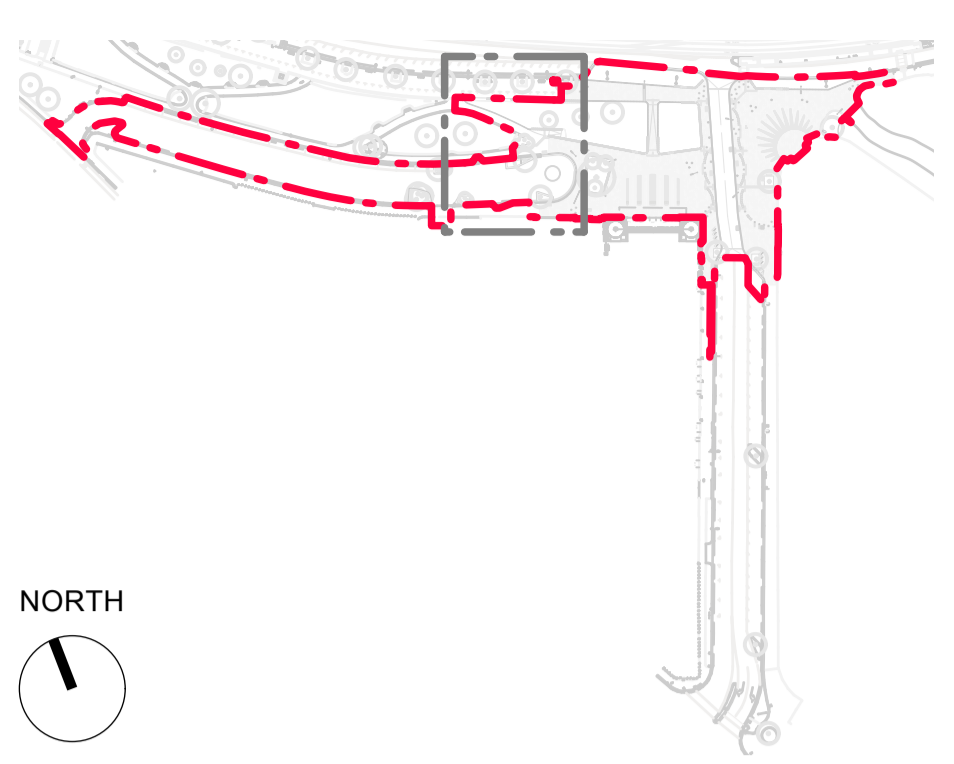

NORTH  
 KEY PLAN  
 1:2500 @ A1 | 1:5000 @ A3

ADJOINS DRAWING LDD-304

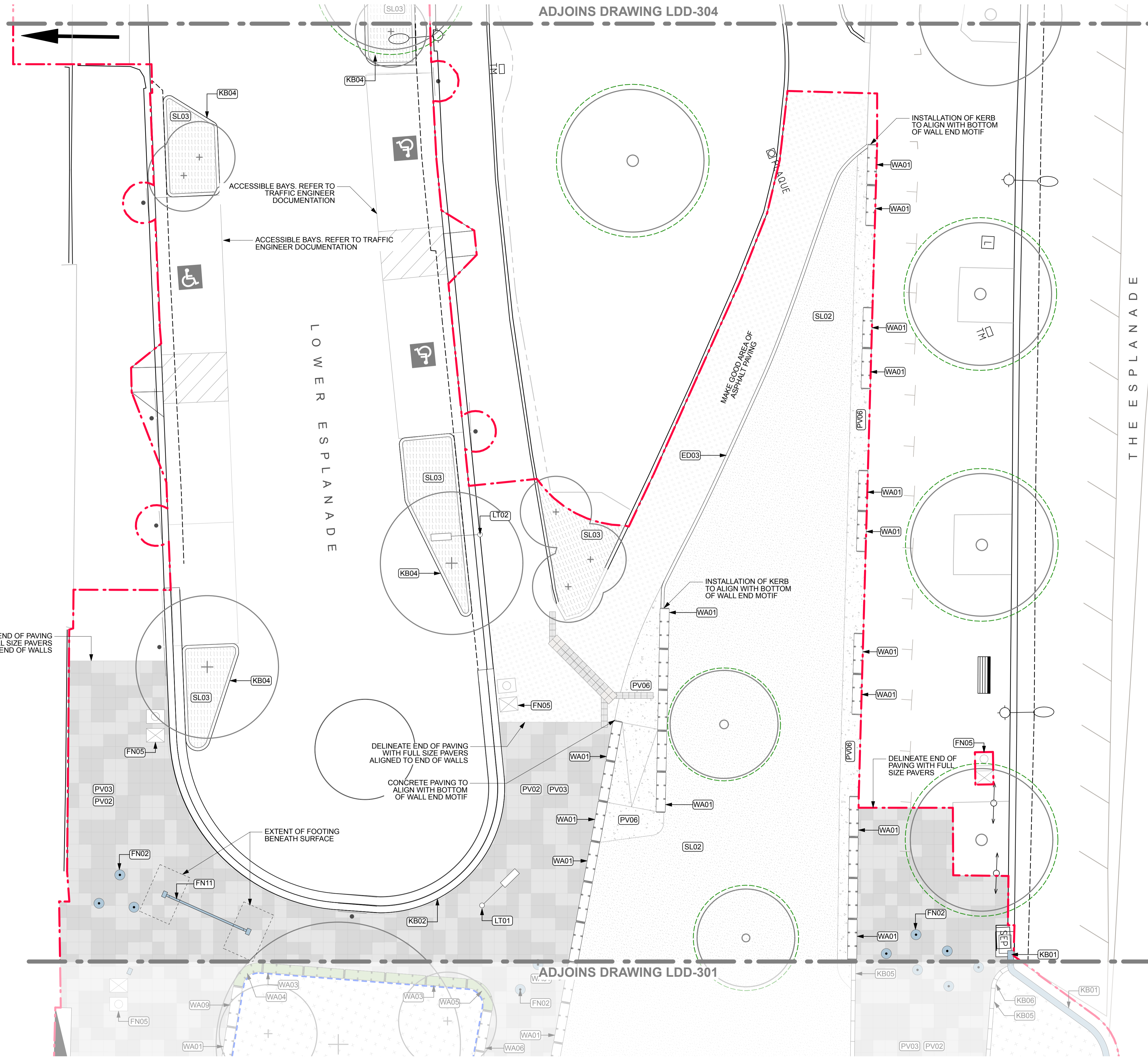

- LEGEND**
- EXTENT OF WORKS
  - EXISTING**
  - TREE TO BE RETAINED  
EXISTING TREES TO BE RETAINED
  - TREE PROTECTION ZONE  
TO BE RETAINED AND PROTECTED
  - ELECTRICITY POLE  
LOCATION FROM SURVEY,  
TO BE RETAINED AND PROTECTED
  - PROPOSED**
  - TREE PLANTING  
REFER PLANTING PLAN & PLANT SCHEDULE
  - DRAIN TYPE 01  
PROPOSED TRENCH DRAIN. REFER CIVIL  
ENGINEER'S DOCUMENTATION
  - PAVEMENT TYPE 02 & 03  
PRECAST LIGHT GREY & MID GREY  
CONCRETE PAVERS
  - PAVEMENT TYPE 06  
INSITU CONCRETE PAVING  
(PEDESTRIAN GRADE)
  - KERB TYPE 01 - HVM  
HIGH PROFILE BARRIER KERB
  - KERB TYPE 02  
RECLAIMED BLUESTONE KERB AND CHANNEL
  - KERB TYPE 04  
BLUESTONE GARDEN BED OUTSTAND
  - KERB TYPE 05  
RAISED PRECAST CONCRETE KERB UNIT
  - EDGE TYPE 03  
CoPP FLUSH CONCRETE EDGE
  - WALL TYPES - 450mm HIGH MODULE  
PRECAST CONCRETE WALL
  - FURNITURE TYPE 02 - HVM  
CUSTOM BOLLARD (HVM)
  - FURNITURE TYPE 05  
CoPP STANDARD LITTER / RECYCLING BIN
  - FURNITURE TYPE 11 - HVM  
GATE WITH CATCH POST
  - LIGHTING TYPE 01  
POLE TOP LIGHT - 12m  
REFER LIGHTING DOCUMENTATION
  - SOFT LANDSCAPE TYPE 02  
LAWN
  - SOFT LANDSCAPE TYPE 03  
MULCH

DELINEATE END OF PAVING  
WITH FULL SIZE PAVERS  
ALIGNED TO END OF WALLS

DELINEATE END OF PAVING  
WITH FULL SIZE PAVERS  
ALIGNED TO END OF WALLS

CONCRETE PAVING TO  
ALIGN WITH BOTTOM  
OF WALL END MOTIF

EXTENT OF FOOTING  
BENEATH SURFACE

INSTALLATION OF KERB  
TO ALIGN WITH BOTTOM  
OF WALL END MOTIF

DELINEATE END OF  
PAVING WITH FULL  
SIZE PAVERS

ADJOINS DRAWING LDD-301

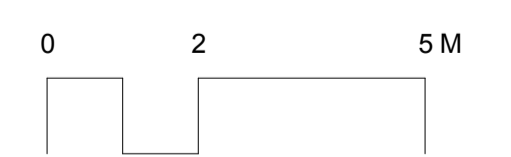

**POLLEN**  
 Pollen Studio Pty Ltd - Landscape Architects  
 BRUNSWICK - Siteworks  
 Studio 1 | Level 1 | 33 Saxon Street VIC 3056  
 03 9329 7548 | pollen@pollenstudio.com.au  
 pollenstudio.com.au | ABN 45 494 020 124



**WARNING**  
 - Beware of underground services. Locations of underground services are indicative only. Their exact position should be proven on site.  
 - Contractor to verify all dimensions on site before commencing work.  
 - Report all discrepancies to Superintendent prior to construction.  
 - Figured dimensions to be taken in preference to scaled drawings.  
 - All drawings may not be distributed without prior permission from the Landscape Architect.

**PROJECT**  
 PALAIS THEATRE & LUNA PARK  
 PRECINCT REVITALISATION  
 Capital Works  
**CLIENT**  
 City of Port Phillip  
 Cnr Carlisle St & Brighton Rd, St Kilda VIC 3182

**CLIENT REFERENCE**  
 -  
**JOB NUMBER**  
 200701

**PHASE**  
 Issue For Tender  
 Package  
**DRAWING TITLE**  
 Surfaces & Finishes  
 Plan

REV.	COMMENT	DATE
A	DRAFT ISSUE FOR TENDER TO CoPP	23.09.21
B	DRAFT ISSUE FOR TENDER TO CoPP	12.11.21
C	FINAL ISSUE FOR TENDER TO CoPP	19.11.21

DRAWN CC CHECK FH

**SCALE**  
 1:100 @ A1 | 1:200 @ A3  
**SHEET**  
 20 of 57  
**DRAWING NO.**  
 LDD-300

**NORTH**  
  
**ISSUE**  
 4

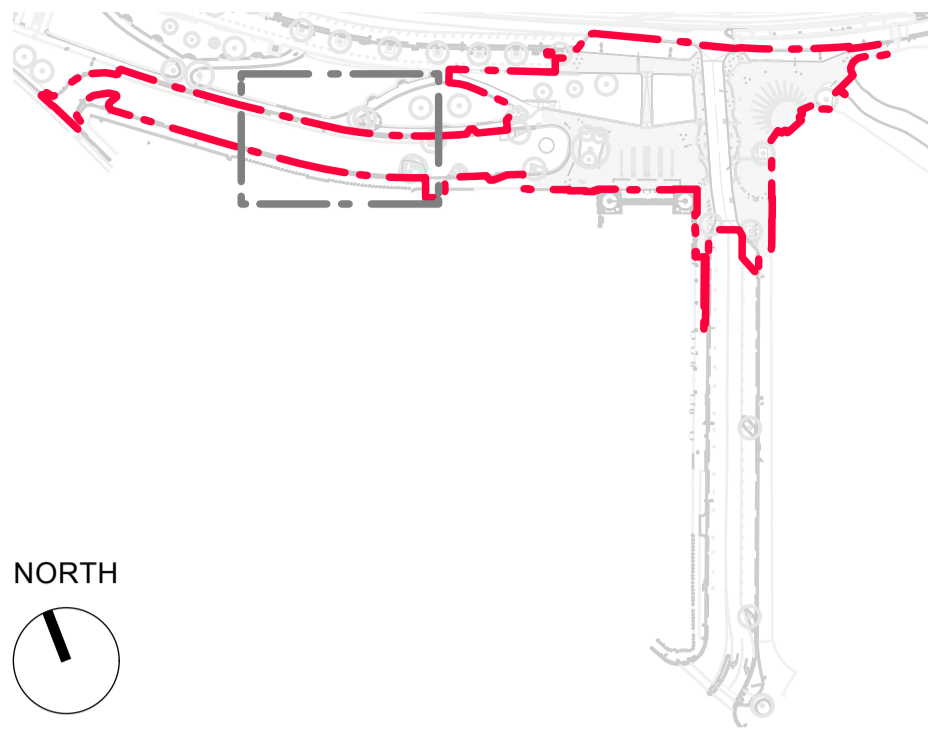

**KEY PLAN**

1:2500 @ A1 | 1:5000 @ A3

**LEGEND**

EXTENT OF WORKS

**EXISTING**  
 TREE TO BE RETAINED  
 EXISTING TREES TO BE RETAINED

TREE PROTECTION ZONE  
 TO BE RETAINED AND PROTECTED

ELECTRICITY POLE  
 LOCATION FROM SURVEY,  
 TO BE RETAINED AND PROTECTED

**PROPOSED**  
 KERB TYPE 04  
 BLUESTONE GARDEN BED OUTSTAND

SOFT LANDSCAPE TYPE 03  
 MULCH

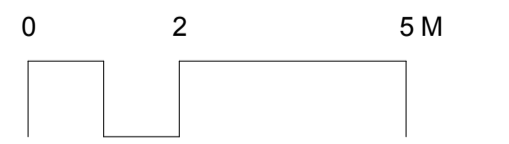
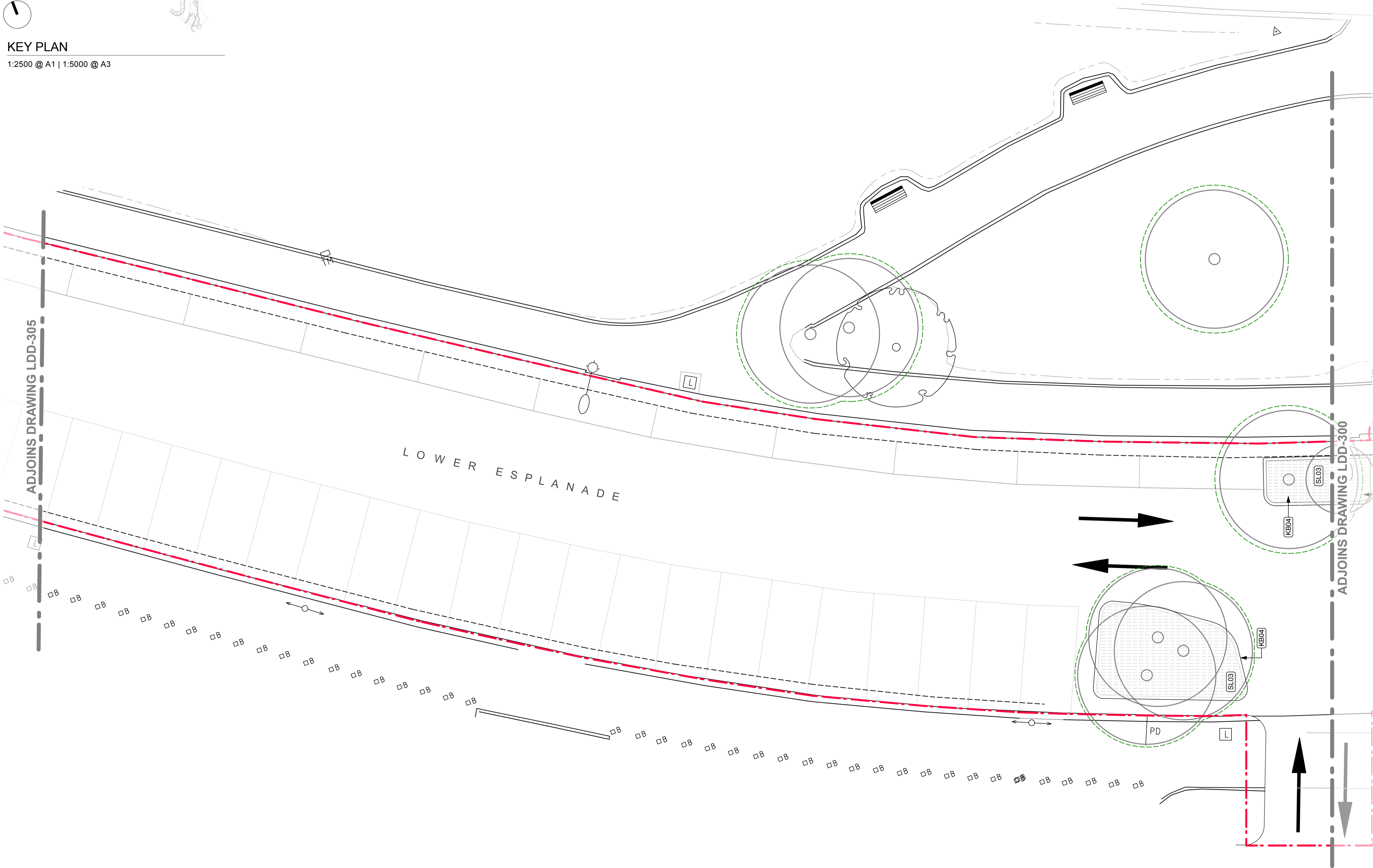

**POLLEN**

Pollen Studio Pty Ltd - Landscape Architects  
 BRUNSWICK - Siteworks  
 Studio 1 | Level 1 | 33 Saxon Street VIC 3056  
 03 9329 7548 | pollen@pollenstudio.com.au  
 pollenstudio.com.au | ABN 45 494 020 124



**WARNING**

- Beware of underground services. Locations of underground services are indicative only. Their exact position should be proven on site.
- Contractor to verify all dimensions on site before commencing work.
- Report all discrepancies to Superintendent prior to construction.
- Figured dimensions to be taken in preference to scaled drawings.
- All drawings may not be distributed without prior permission from the Landscape Architect.

NOT FOR CONSTRUCTION

PROJECT  
**PALAIS THEATRE & LUNA PARK  
 PRECINCT REVITALISATION**  
 Capital Works

CLIENT  
**City of Port Phillip**  
 Cnr Carlisle St & Brighton Rd, St Kilda VIC 3182

CLIENT REFERENCE

JOB NUMBER  
 200701

PHASE

**Issue For Tender  
 Package**

DRAWING TITLE

**Surfaces & Finishes  
 Plan**

REV. COMMENT

REV.	COMMENT	DATE
A	DRAFT ISSUE FOR TENDER TO CoPP	23.09.21
B	DRAFT ISSUE FOR TENDER TO CoPP	12.11.21
C	FINAL ISSUE FOR TENDER TO CoPP	19.11.21

DRAWN CC

CHECK FH

SCALE

1:100 @ A1 | 1:200 @ A3

SHEET

24 of 57

DRAWING NO.

**LDD-304**

NORTH

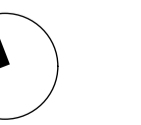

ISSUE

**4**

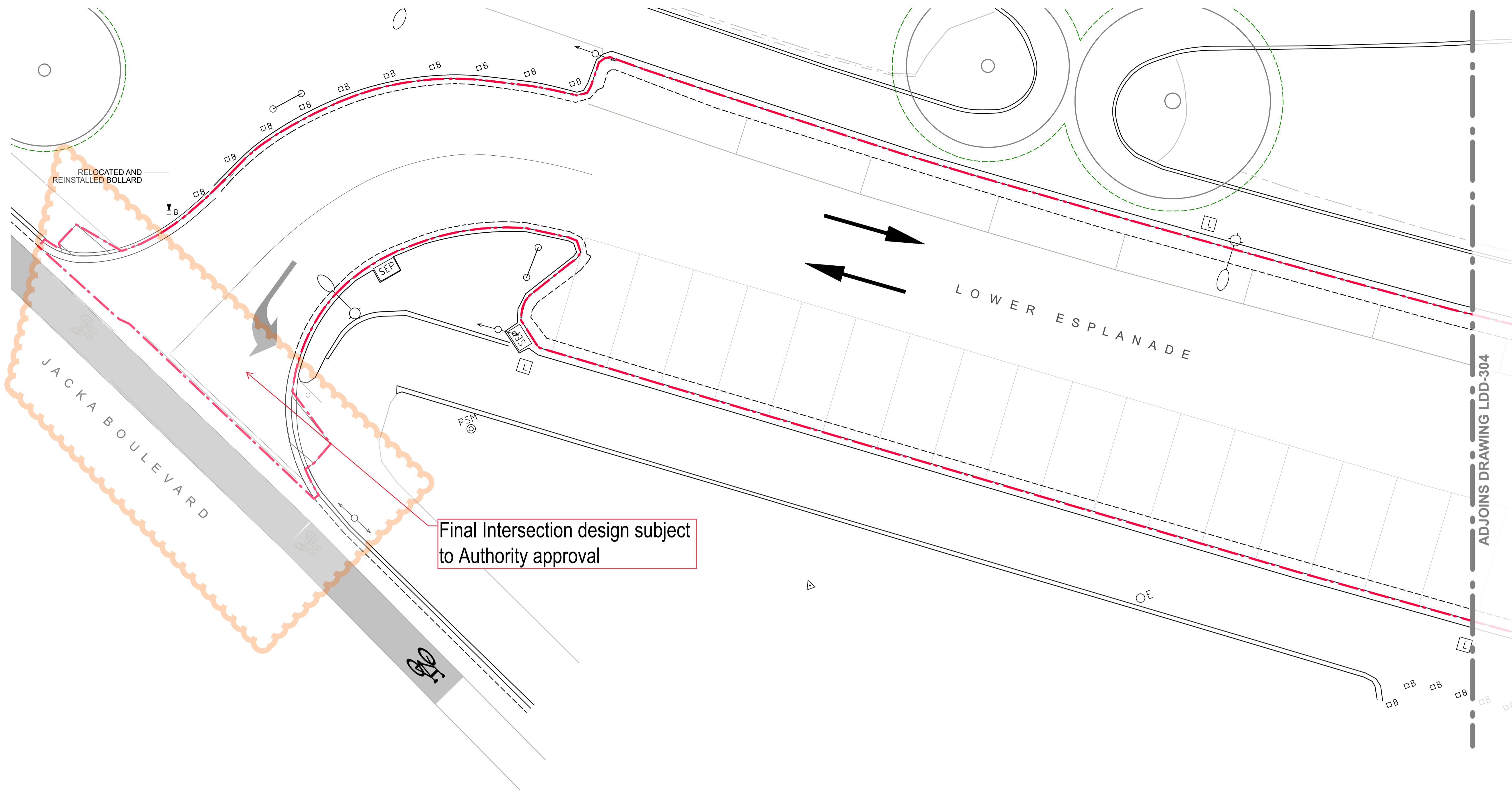

**LEGEND**

- EXTENT OF WORKS
- EXISTING
  - TREE TO BE RETAINED  
EXISTING TREES TO BE RETAINED
  - TREE PROTECTION ZONE  
TO BE RETAINED AND PROTECTED
  - ELECTRICITY POLE  
LOCATION FROM SURVEY,  
TO BE RETAINED AND PROTECTED



NORTH

**KEY PLAN**

1:2500 @ A1 | 1:5000 @ A3

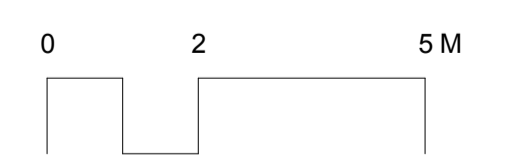

**POLLEN**

Pollen Studio Pty Ltd - Landscape Architects  
BRUNSWICK - Siteworks  
Studio 1 | Level 1 | 33 Saxon Street VIC 3056  
03 9329 7548 | pollen@pollenstudio.com.au  
pollenstudio.com.au | ABN 45 494 020 124



**WARNING**

- Beware of underground services. Locations of underground services are indicative only. Their exact position should be proven on site.  
- Contractor to verify all dimensions on site before commencing work.  
- Report all discrepancies to Superintendent prior to construction.  
- Figured dimensions to be taken in preference to scaled drawings.  
- All drawings may not be distributed without prior permission from the Landscape Architect.

NOT FOR CONSTRUCTION

PROJECT  
**PALAIS THEATRE & LUNA PARK  
PRECINCT REVITALISATION**  
Capital Works

CLIENT  
**City of Port Phillip**  
Cnr Carlisle St & Brighton Rd, St Kilda VIC 3182

CLIENT REFERENCE  
-

JOB NUMBER  
200701

PHASE  
**Issue For Tender  
Package**

DRAWING TITLE  
**Surfaces & Finishes  
Plan**

REV. COMMENT	DATE
A DRAFT ISSUE FOR TENDER TO CoPP	23.09.21
B DRAFT ISSUE FOR TENDER TO CoPP	12.11.21
C FINAL ISSUE FOR TENDER TO CoPP	19.11.21

DRAWN CC CHECK FH

SCALE  
1:100 @ A1 | 1:200 @ A3

SHEET  
25 of 57

DRAWING NO.  
**LDD-305**

NORTH

ISSUE  
**4**