

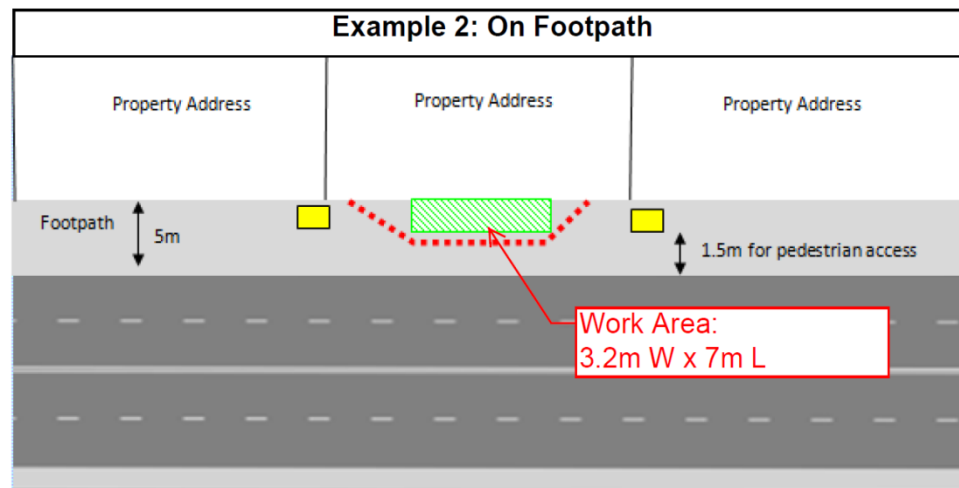

# Traffic Management Plan Example

Traffic management plans must show all safety features for vehicular and pedestrian safety.

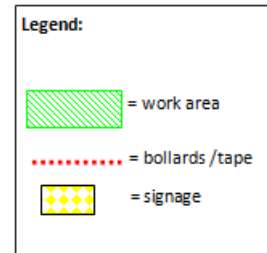
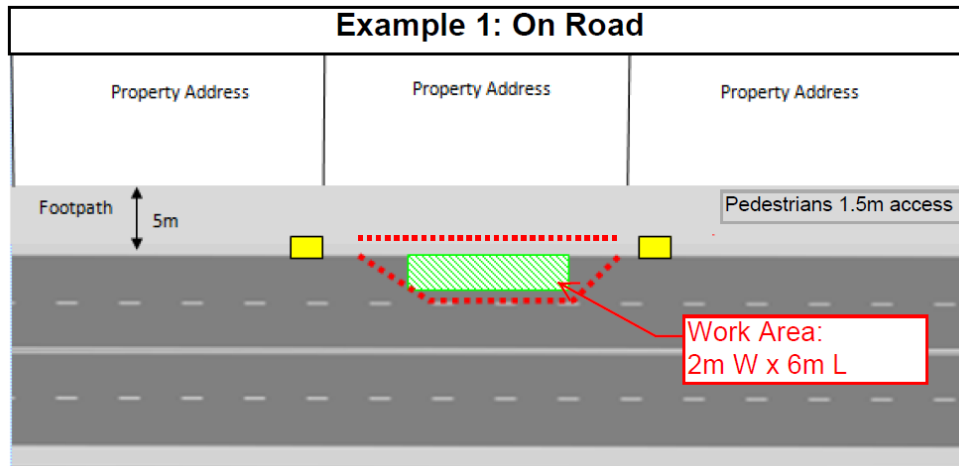

The following must be included in your TMP:

- Length and Width of the work area you propose to occupy
- Appropriate safety signage, for example "pedestrian watch your step", or "use other footpath"
- Bollards/tape or similar around your work area
- Pedestrian clearance (minimum 1.5m to allow for access).
- Work location (site address)
- Street names and any intersecting streets/ or laneways
- Council assets near your work area ( eg: trees, bus stops, bicycle hoops)

Complex jobs may require professional traffic management consultation.